

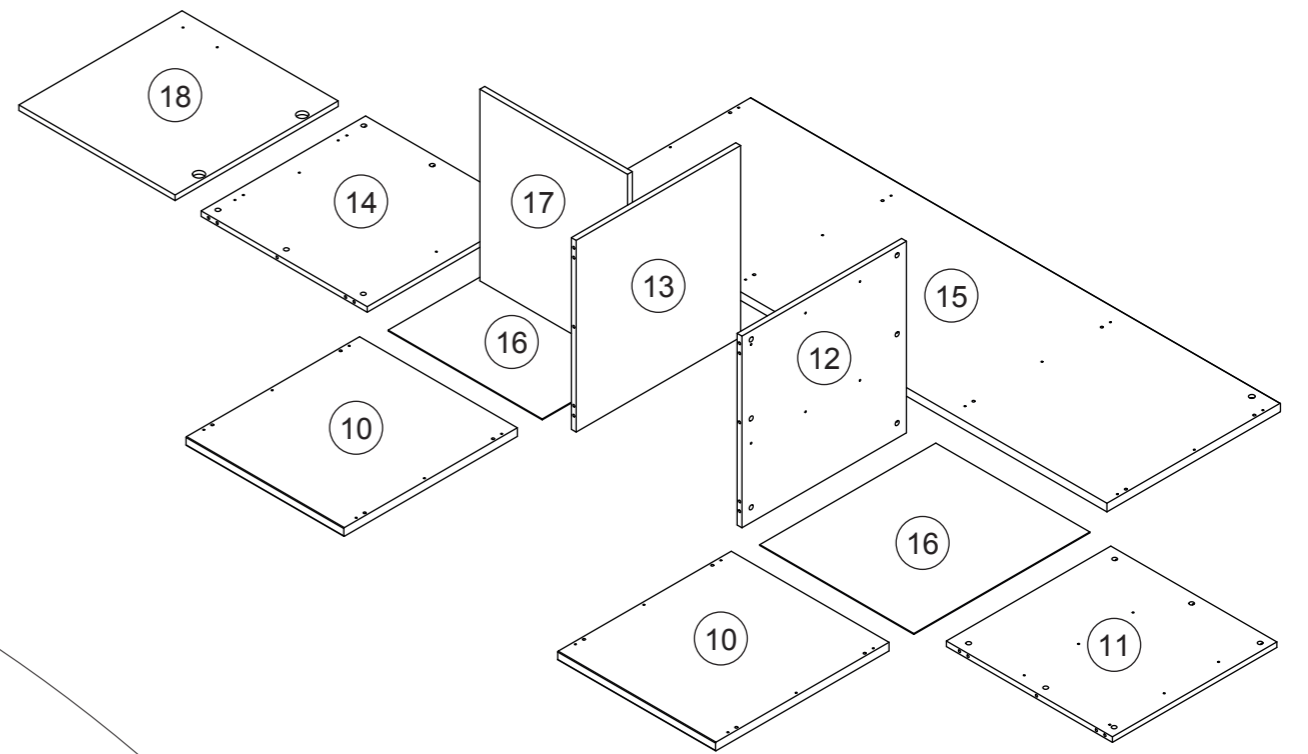

montage instructies
instructions de montage
assembly instructions
montage anleitung

TOMMY

HSL

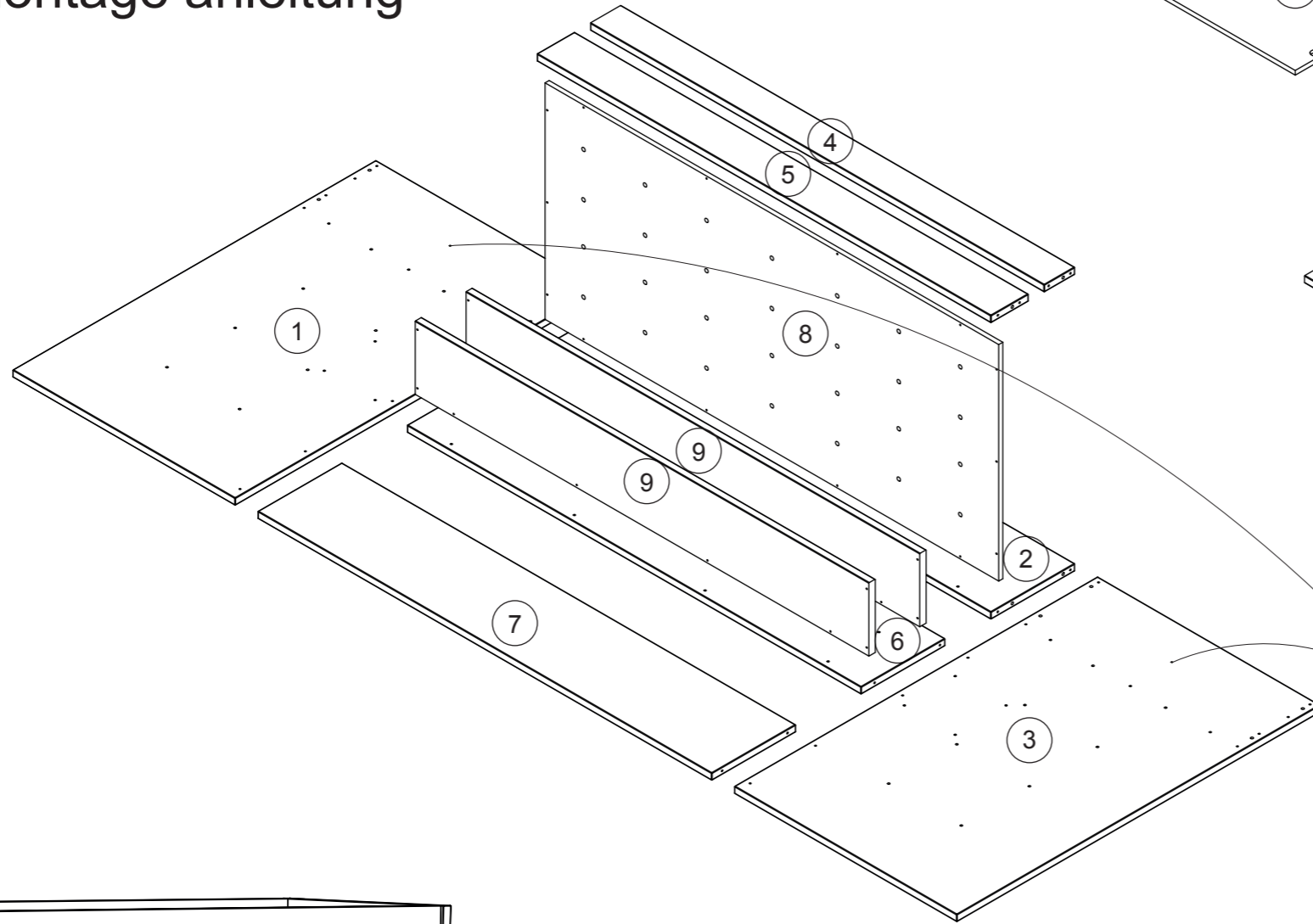

Dit gaatje duidt de maximum hoogte aan van de matras.
Ce petit trou indique l'hauteur maximale du matelas.
This small hole indicates the maximum height of the mattress.
Diese Bohrung zeigt die maximale Höhe der Matratze an.

x 3

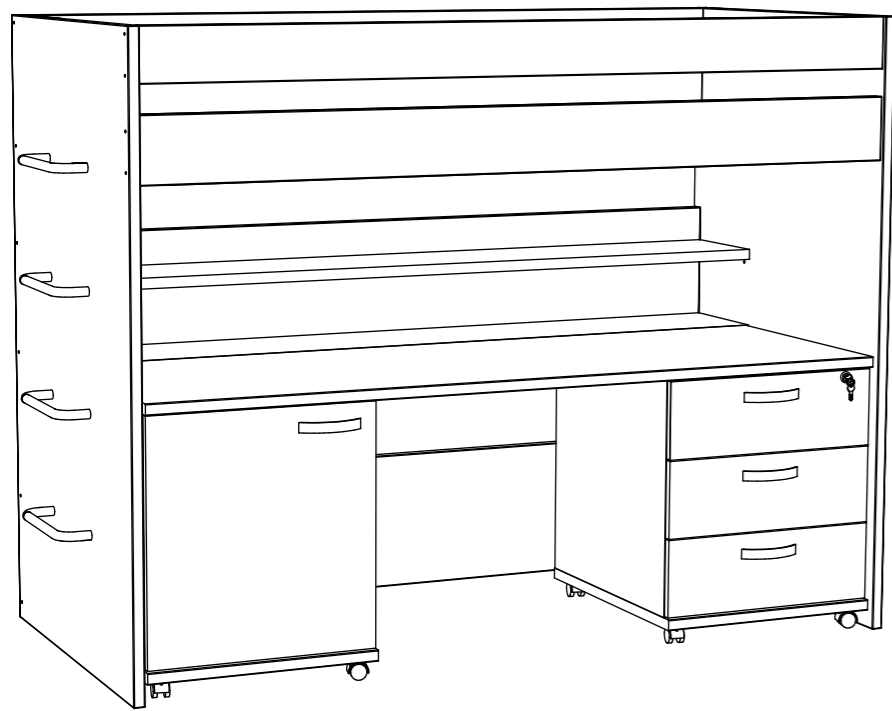
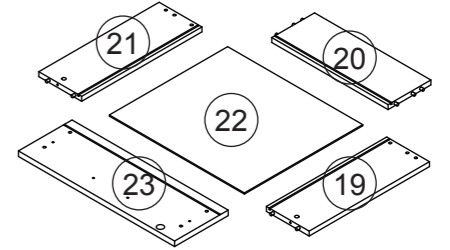

HSL 206 x 160 x 98 cm

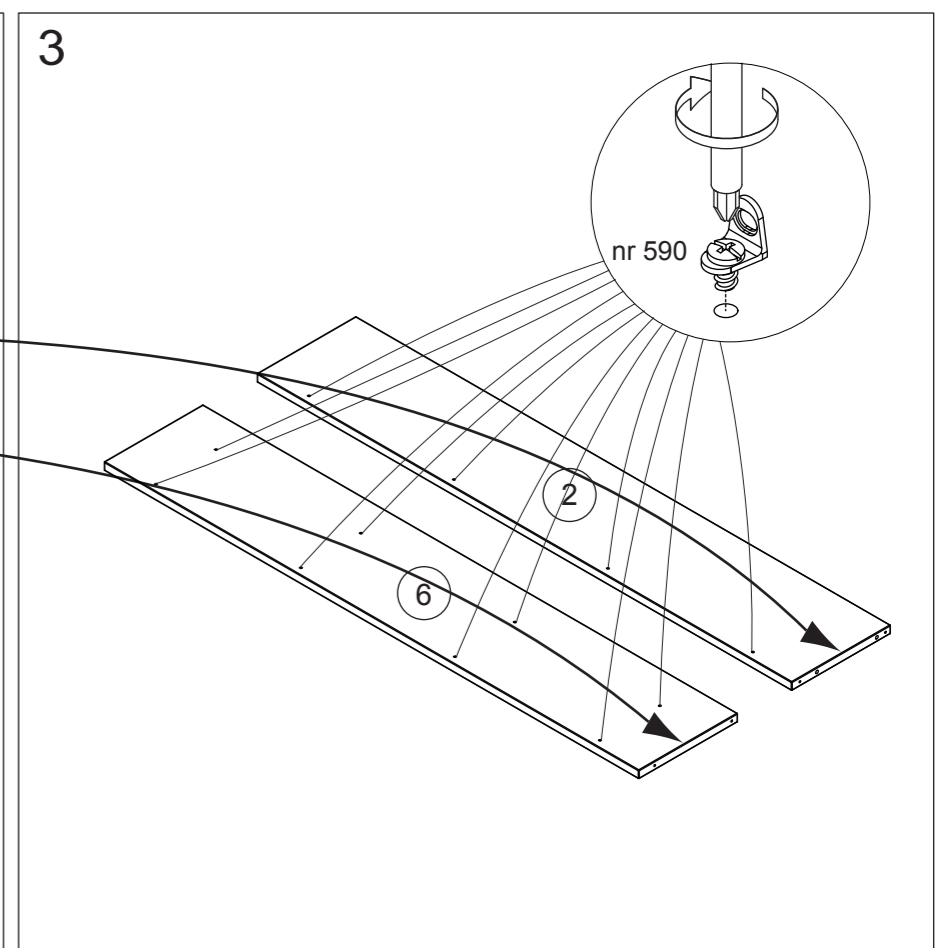
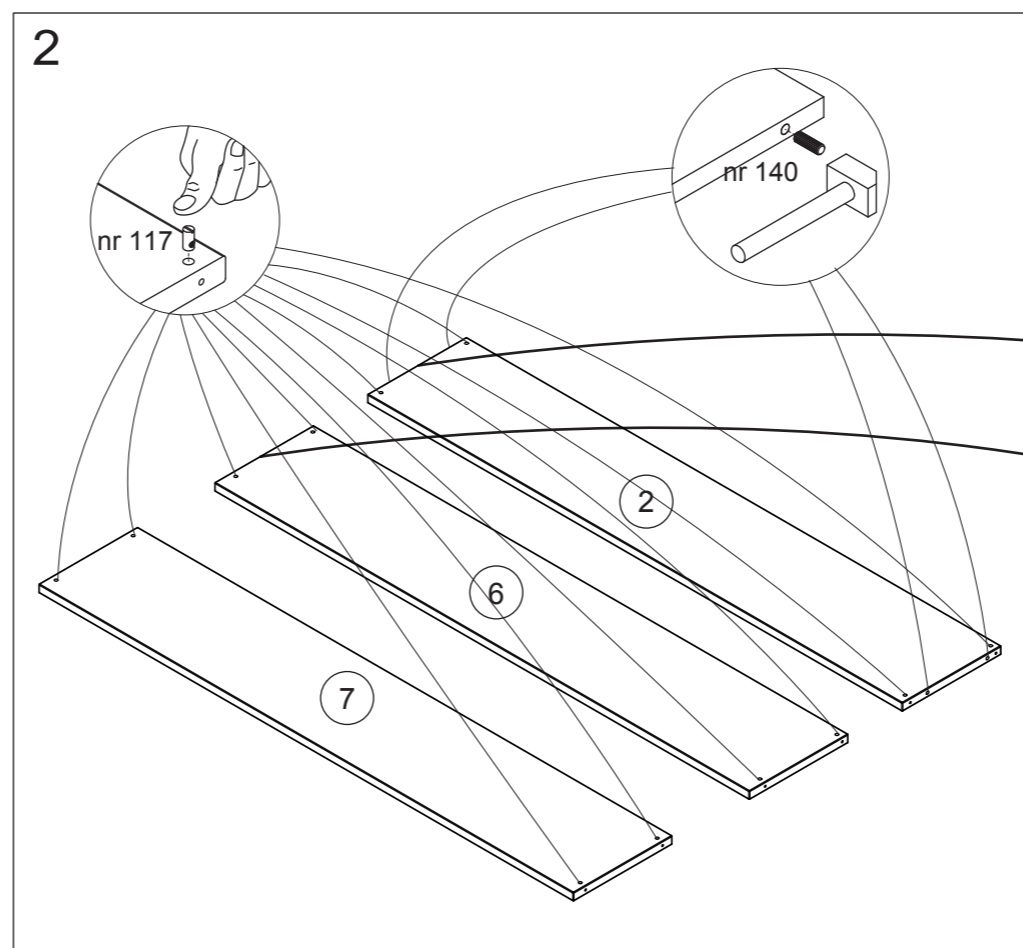
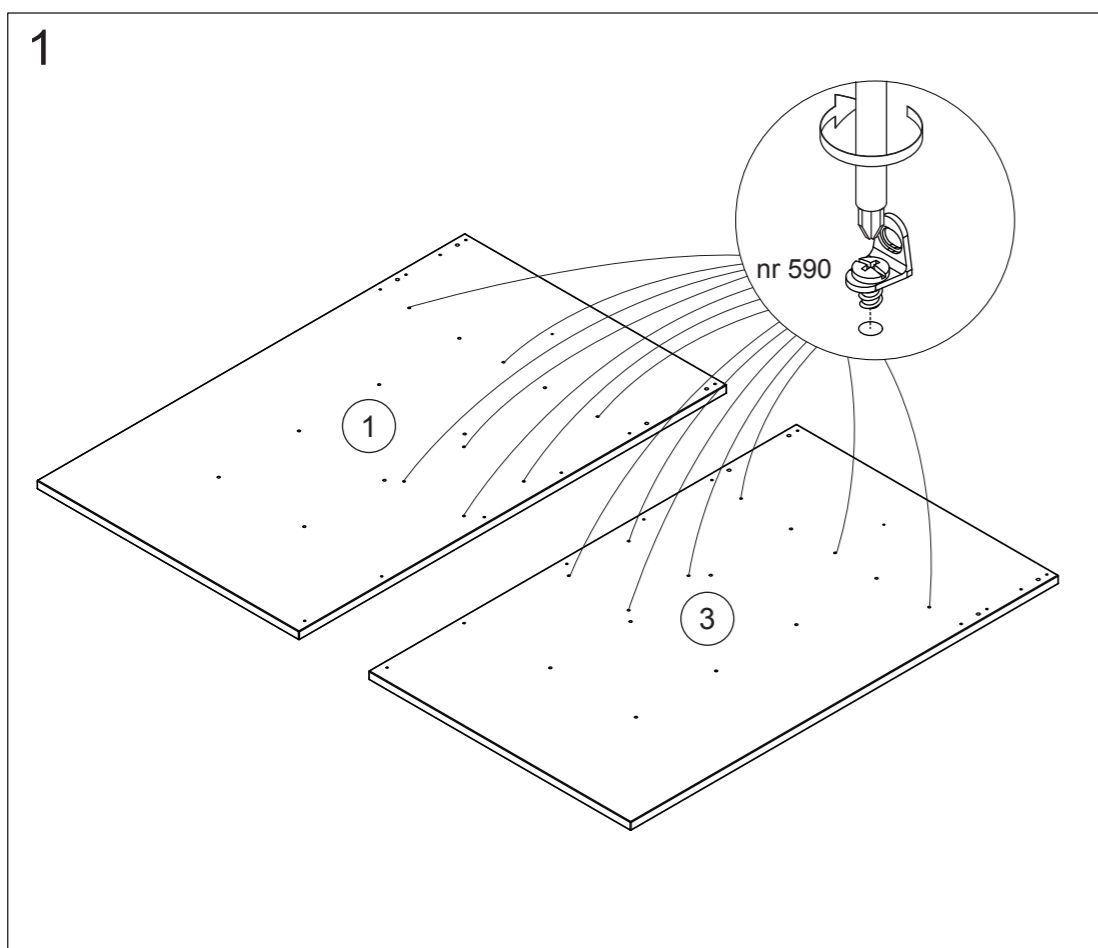
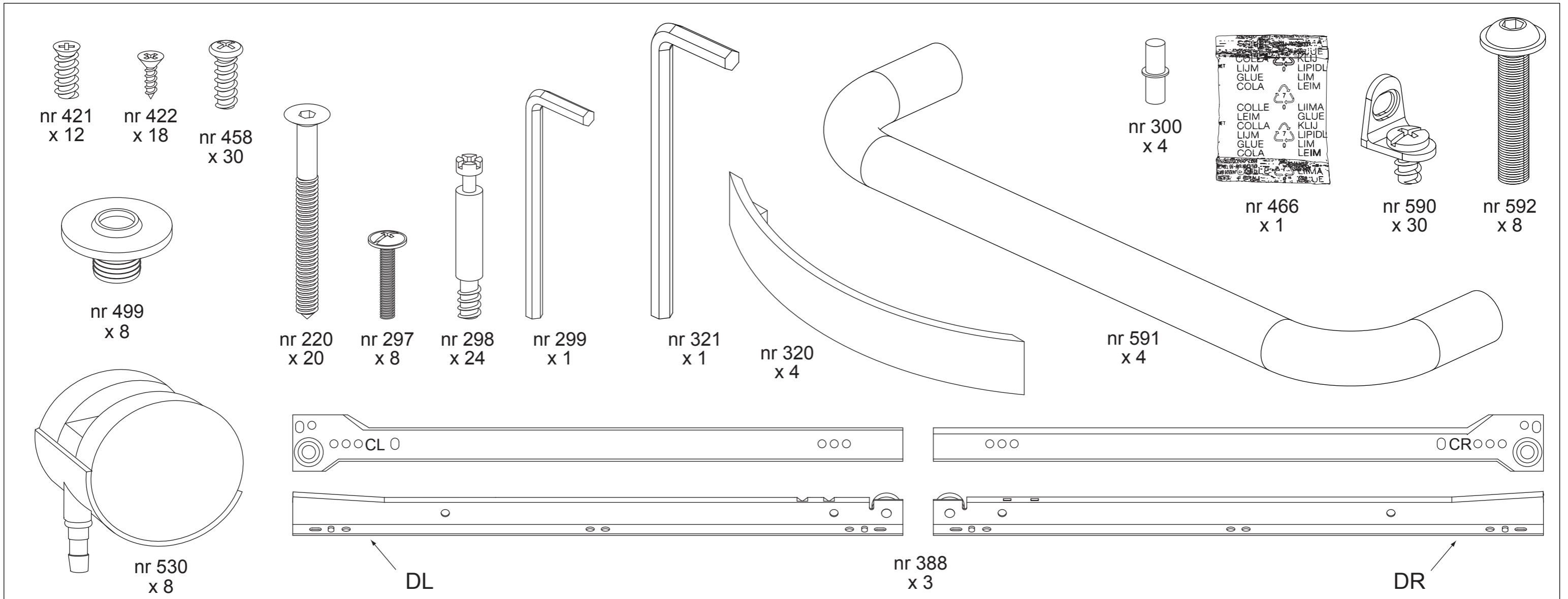
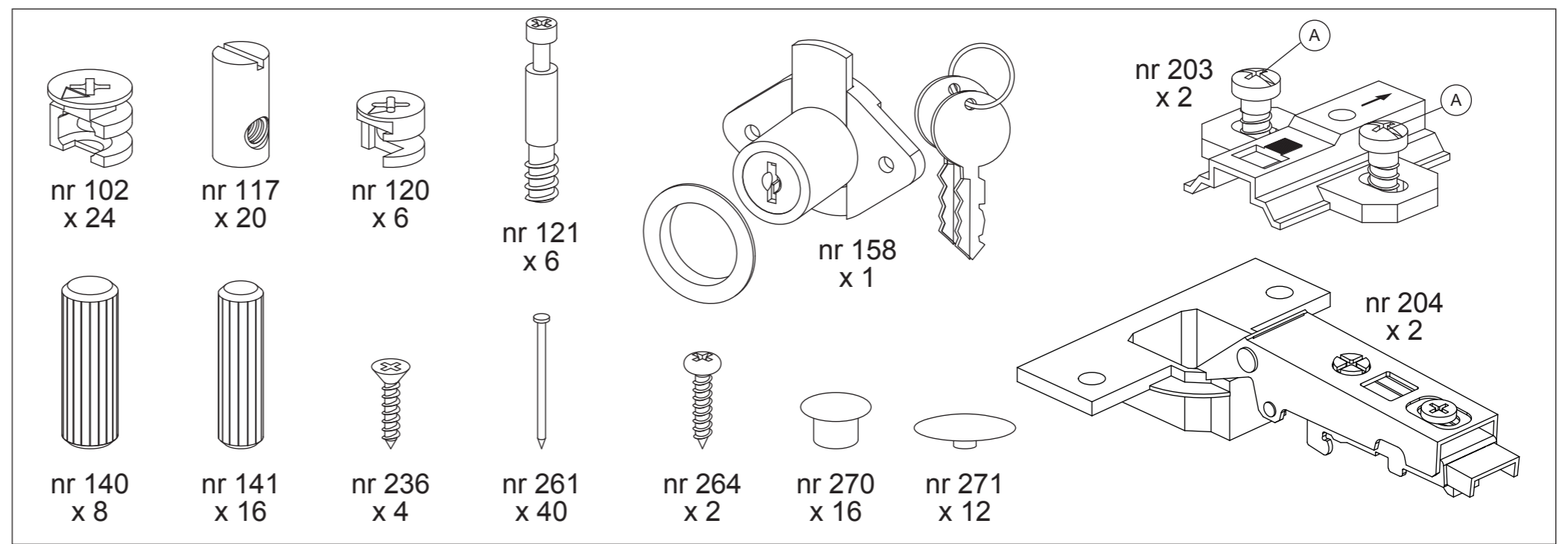

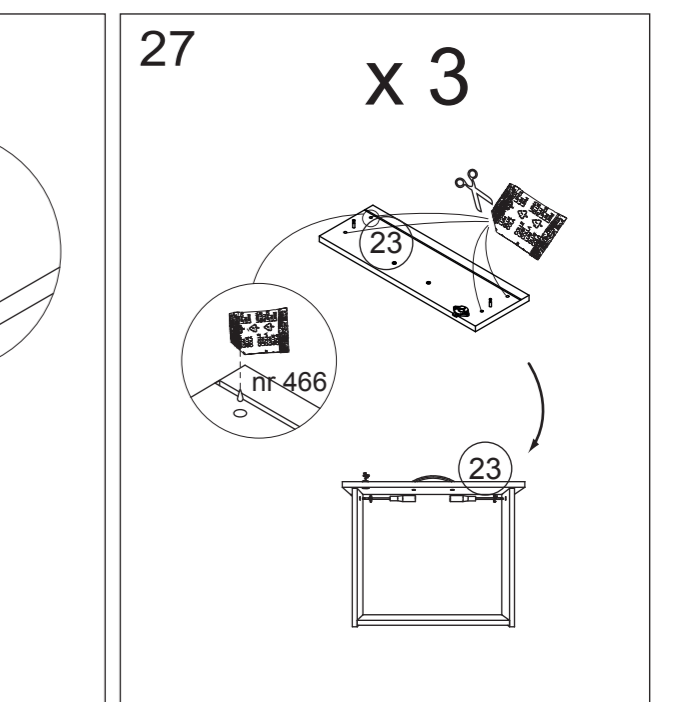
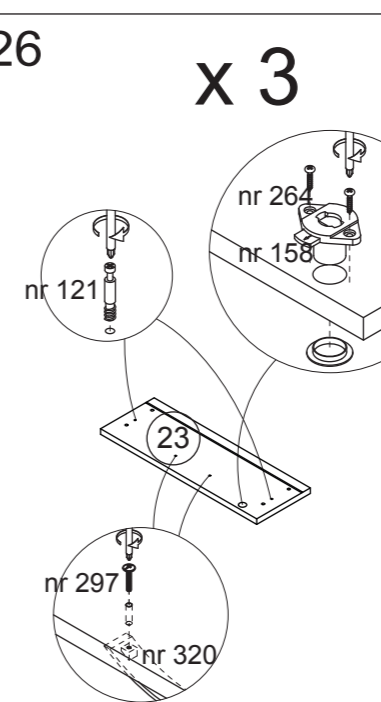
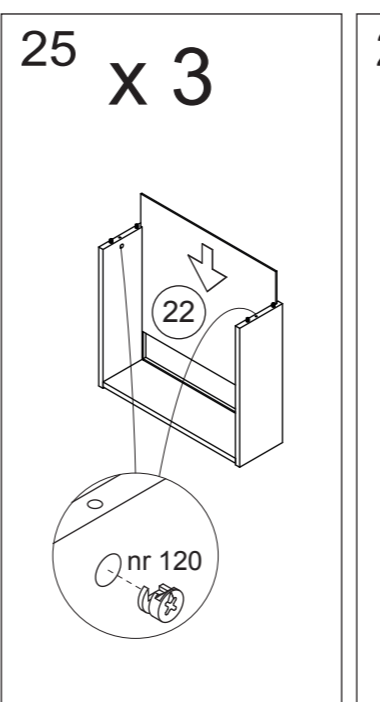
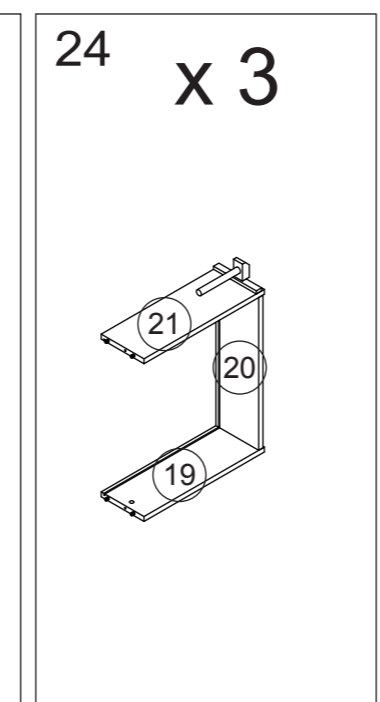
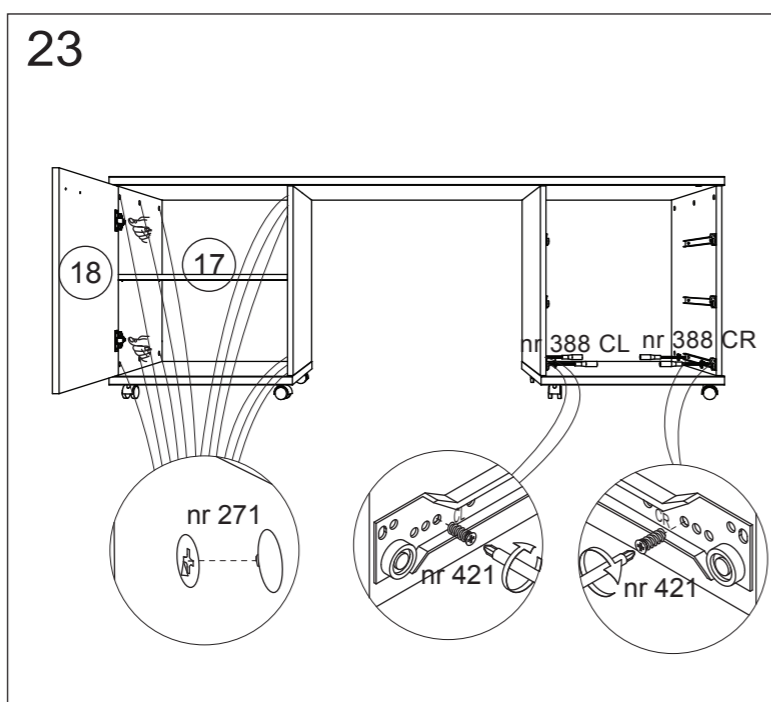
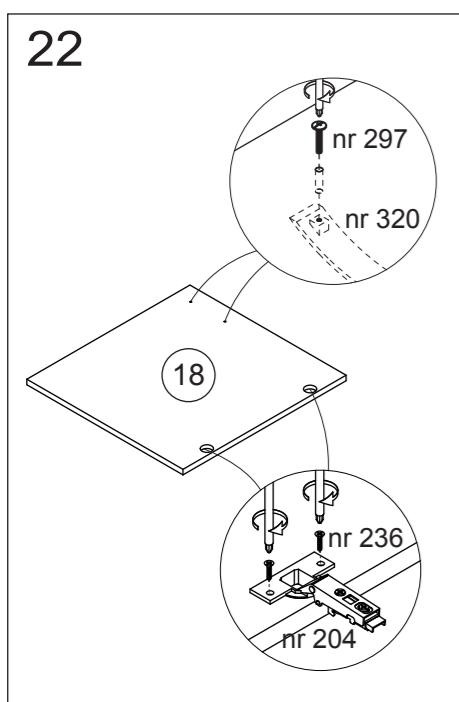
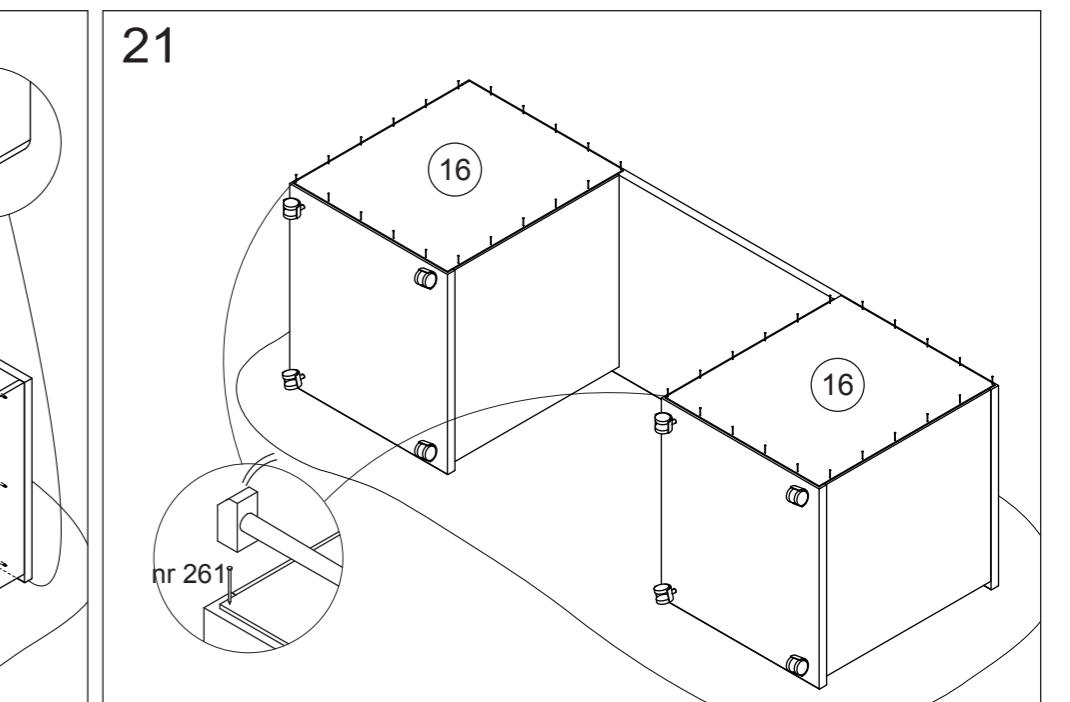
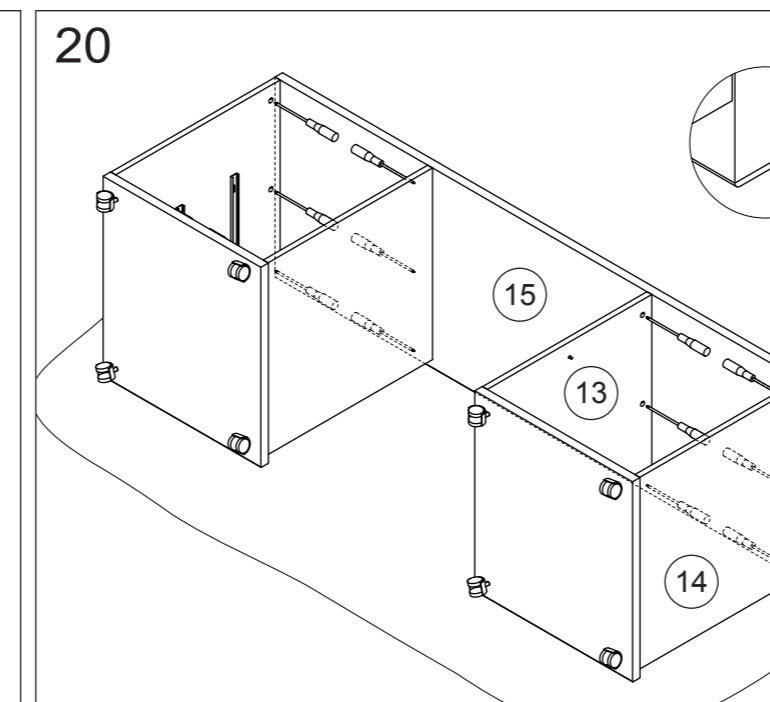
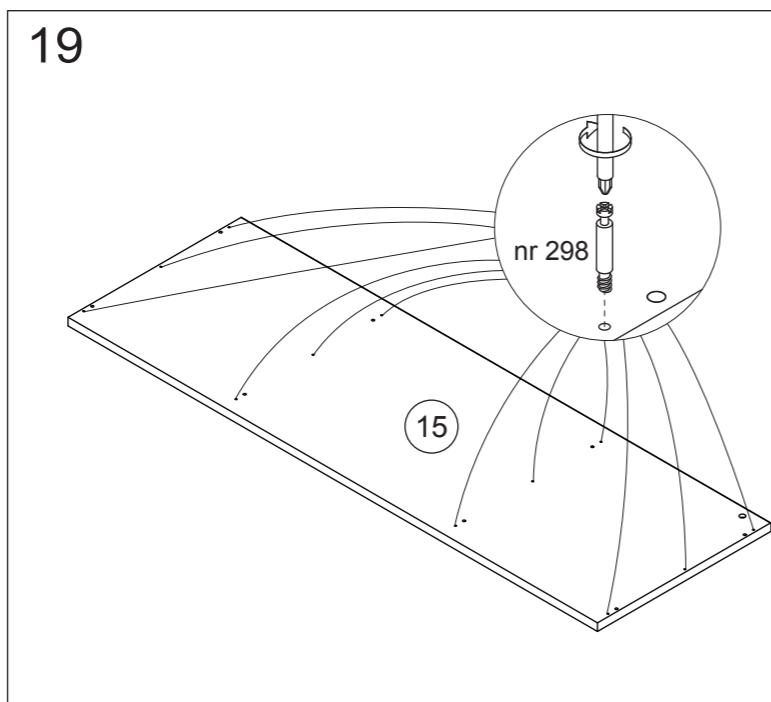
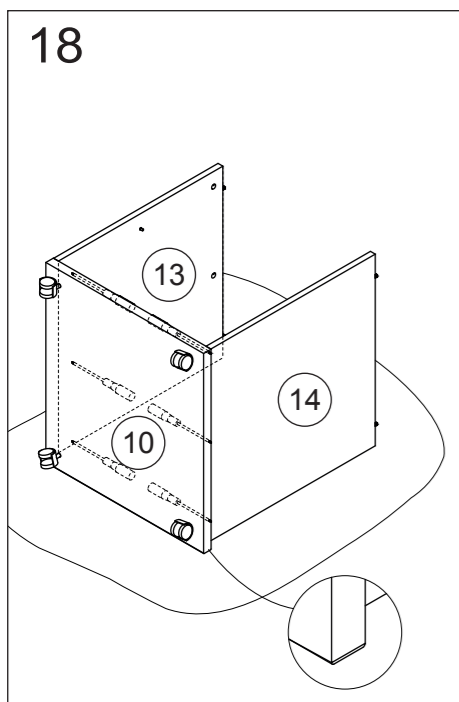
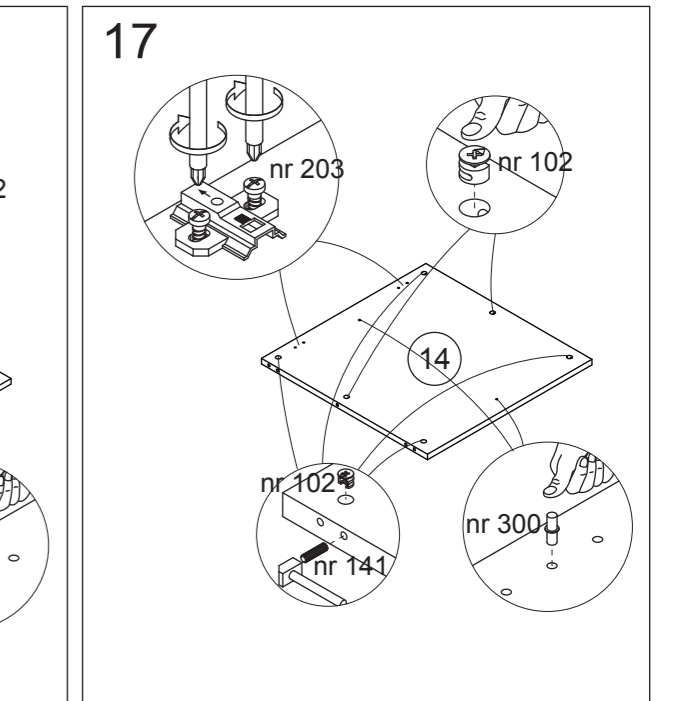
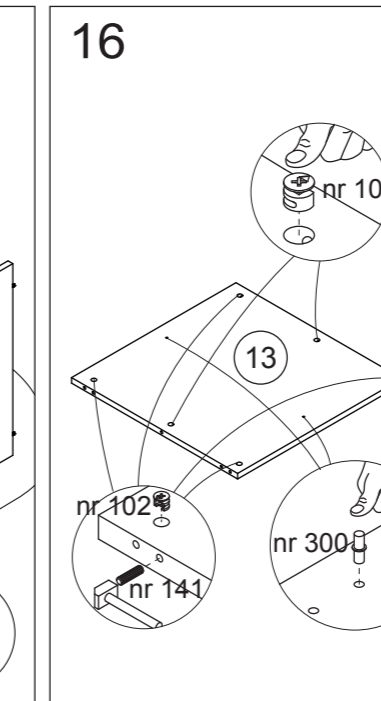
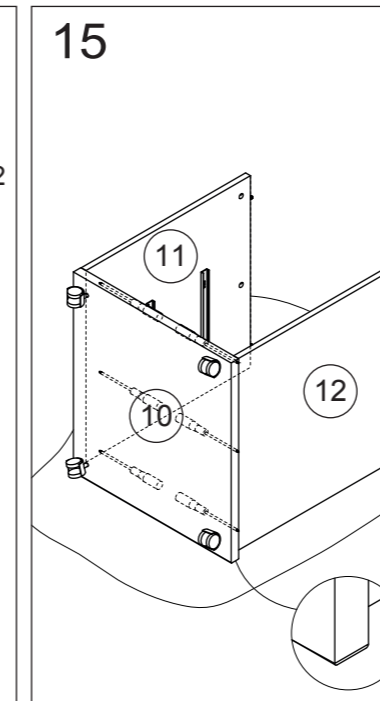
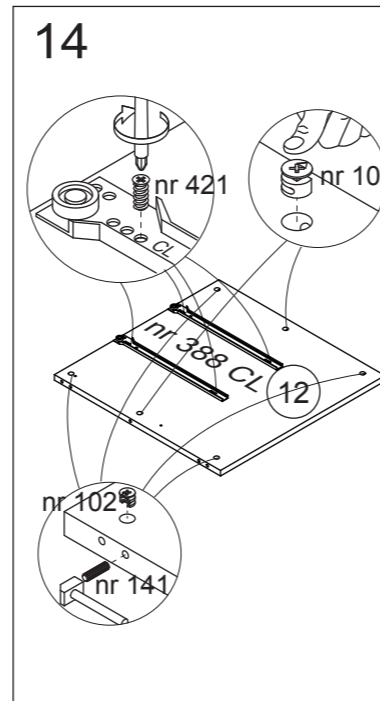
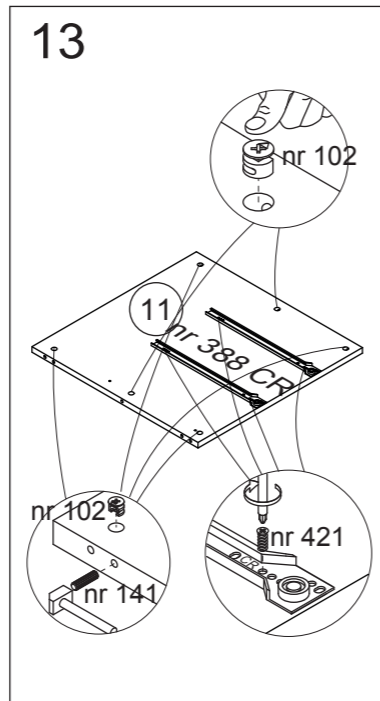
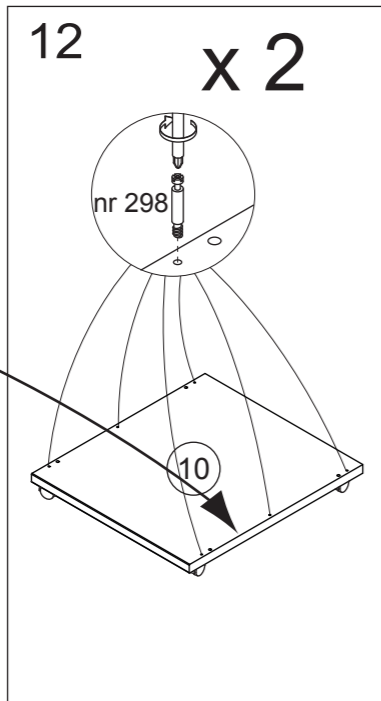
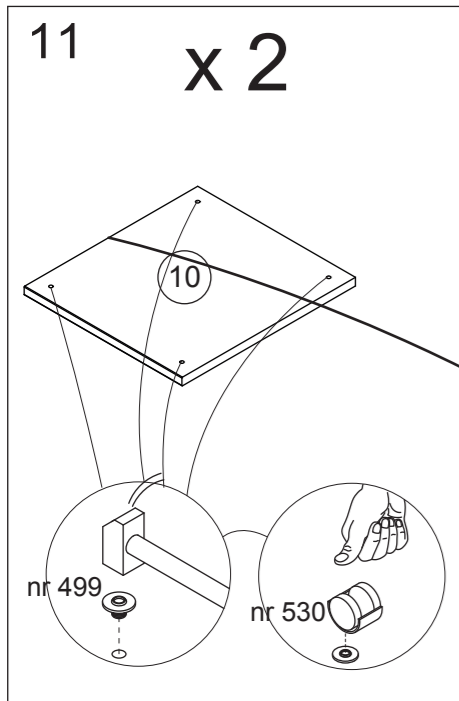
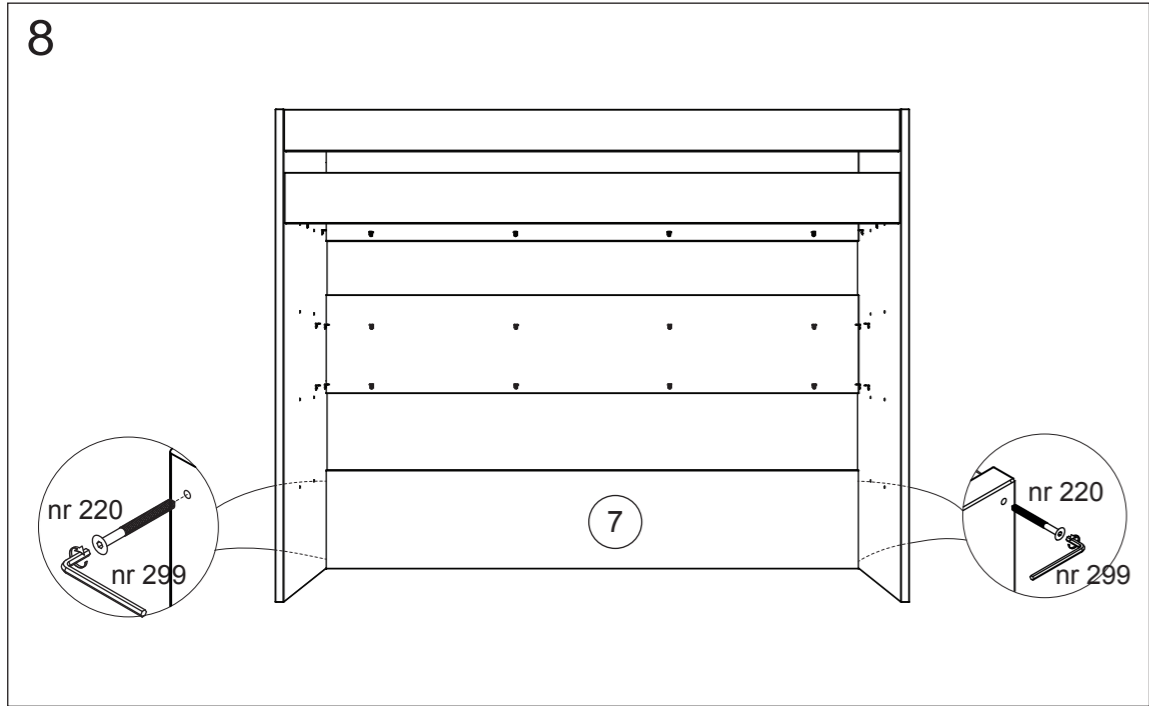
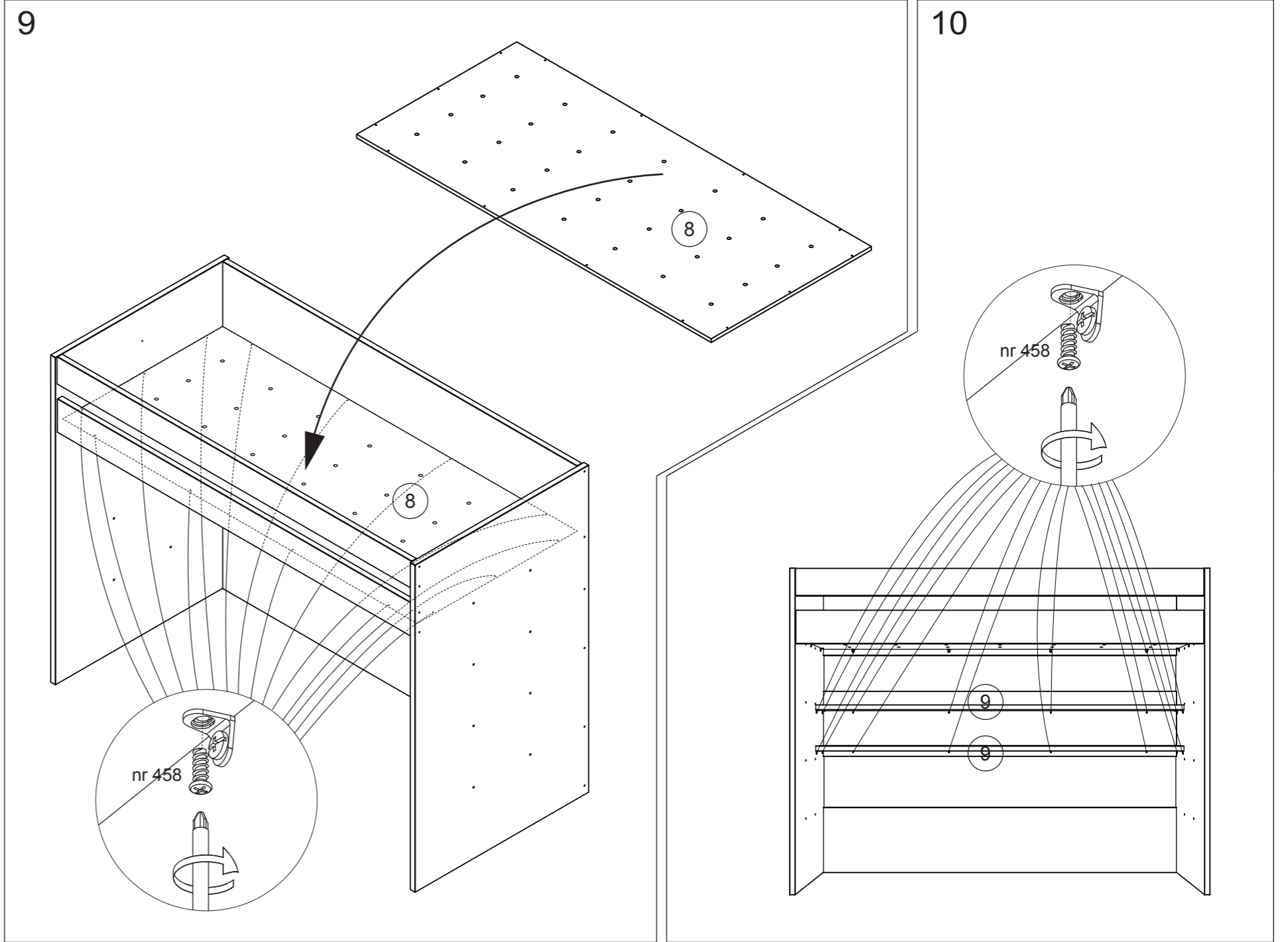
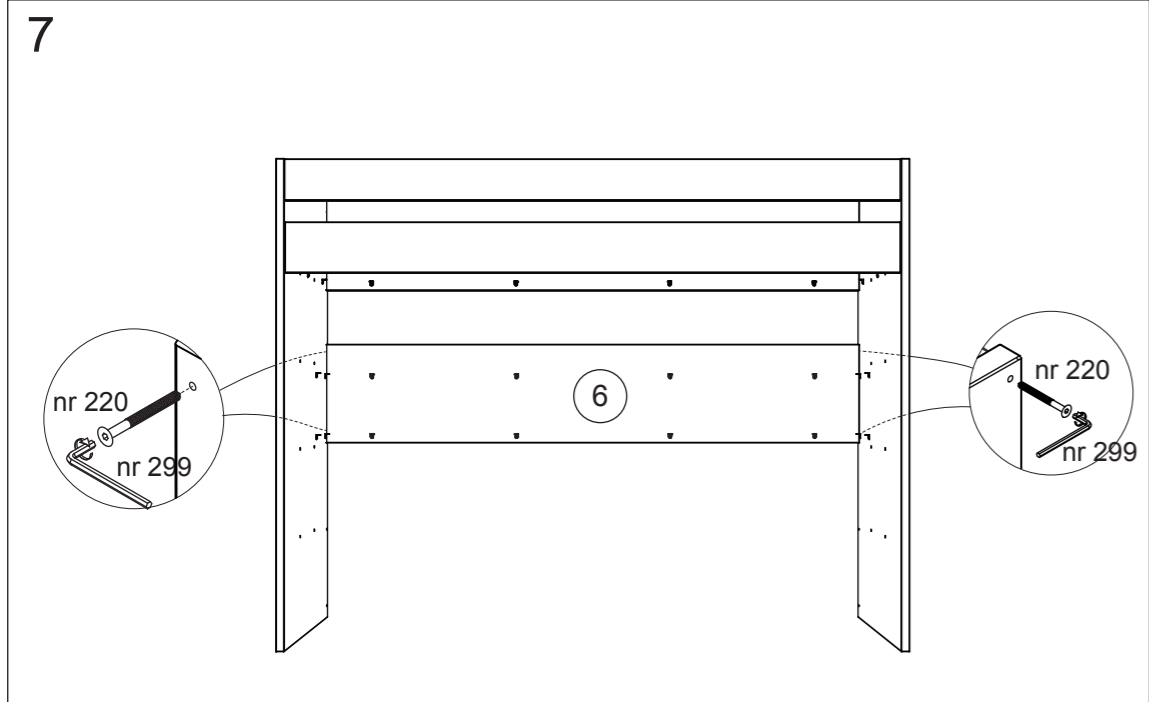
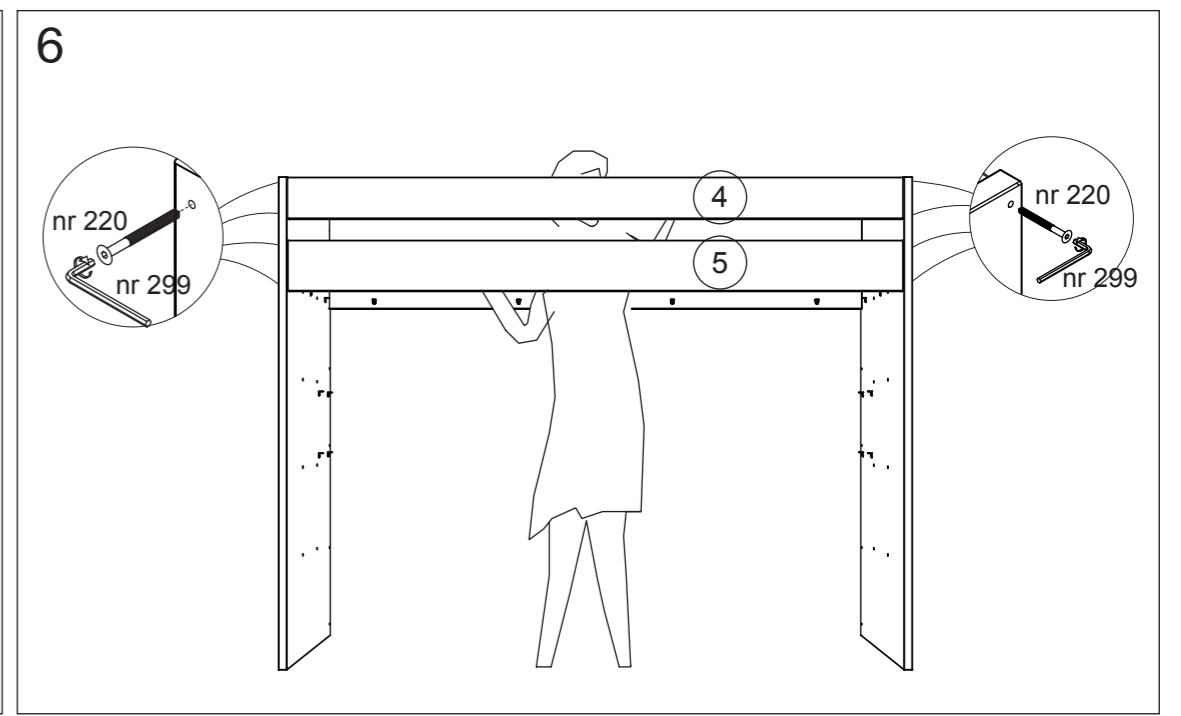
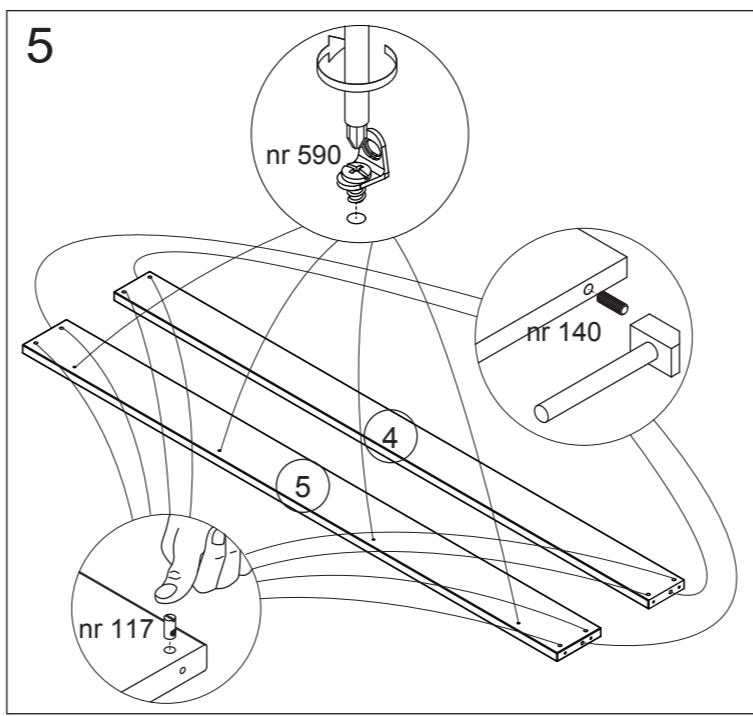
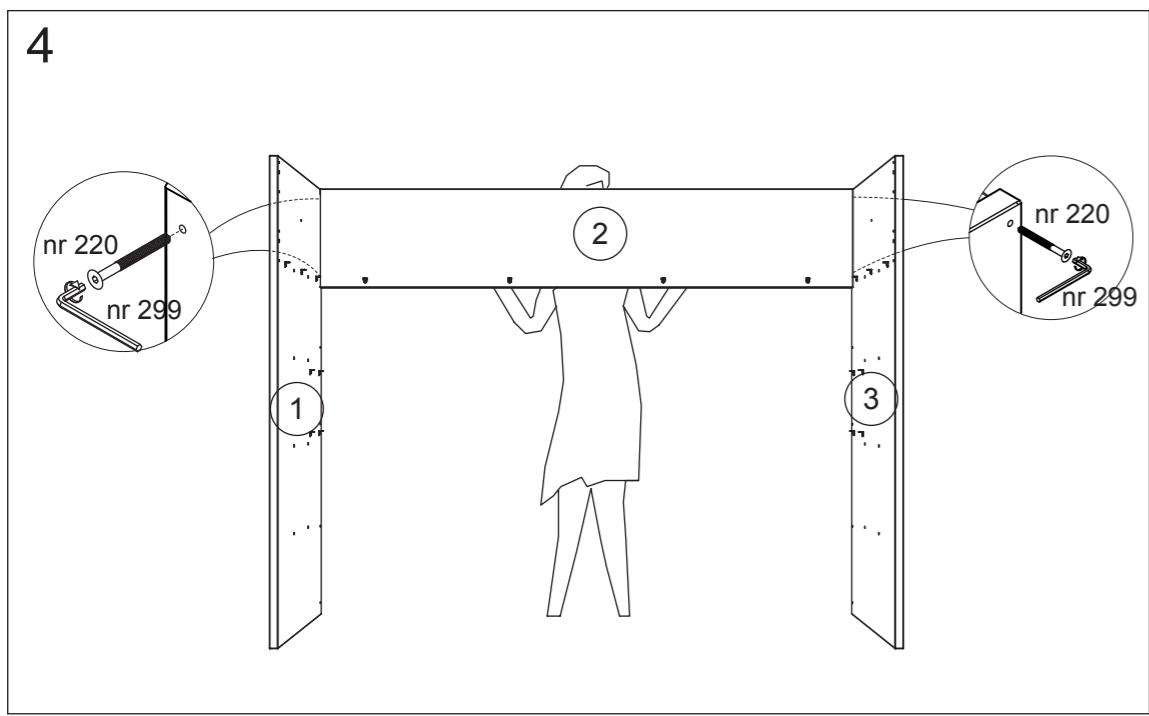

28

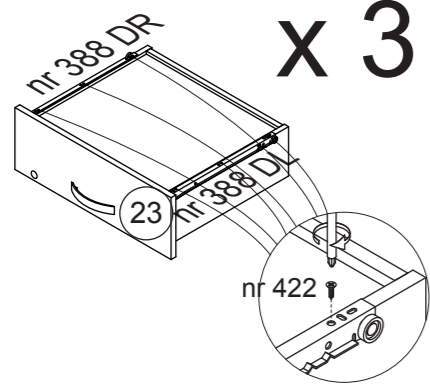

x 3

30

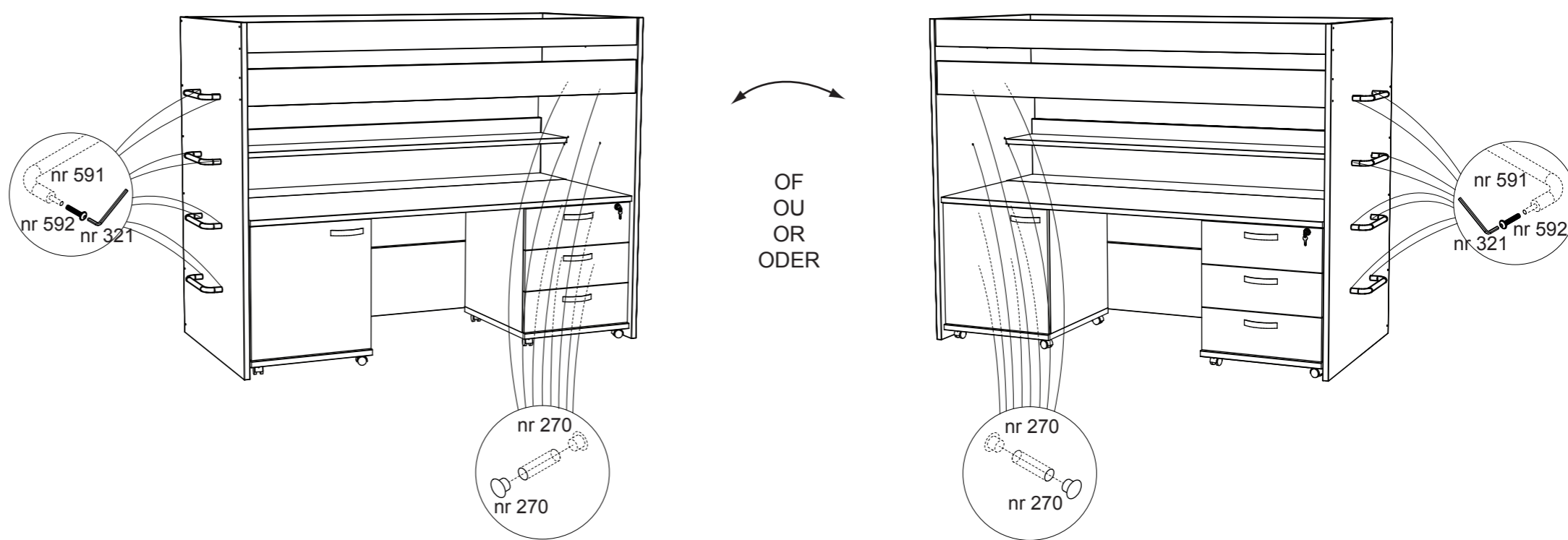

29

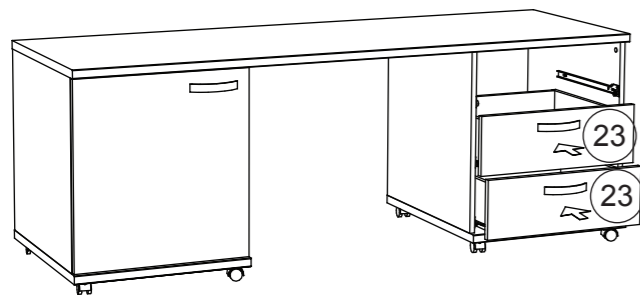

Voor de juiste regeling van de deuren moet U ervoor zorgen dat de kast goed waterpas staat, ook kunt U met de schroeven van de scharnieren 204 de deur bijregelen. U kan ook de deuren vertikaal bijregelen. Ontspan vijzen A en schuif de scharnierblok nr. 203 naar onder of naar boven en schroef terug vast.

Pour un règlement des portes, l'armoire doit être de niveau, vous pouvez aussi régler les portes avec les vis des charnières 204. Vous pouvez aussi régler la porte verticalement. Dévissez vis A et glissez le blocque de charnière n° 203 en bas ou en haut et vissez de nouveau.

For the adjustment of the doors, the unit has to be at level, you can also adjust the doors with the screws of the hinge 204. You can also adjust the door vertically. Unbend the screws A and slide the hinge block nr. 203 down or up and tighten again.

Für die richtige Einstellung der Tür, sollte der Schrank waagrecht stehen. Mit den Schrauben am Scharnier 204 können Sie die Tür einstellen. Um die Tür in der Höhe zu verstellen, müssen Sie die Schrauben A vom Scharnierblock 203 lösen, die Tür nach unten oder oben verschieben und die Schraube wieder festschrauben.