

**2**  
h

**00**  
mn



**OUTILLAGES**

(GB)

(D)

(E)

(P)

(I)

(NL)

TOOLS

HANDWERKZEUGE

HERRAMIENTAS

FERRAMENTAS

ATTREZZATURA

GEREEDSCHAP

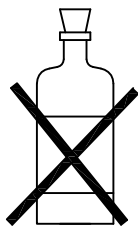
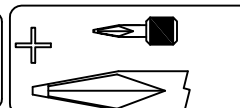
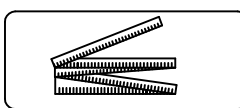
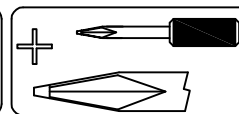
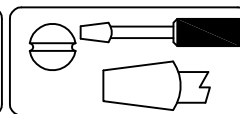
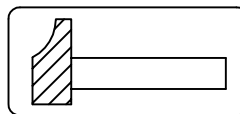

**SOLVANT**

- (GB) DILUANT  
(D) LOSUNGSMITTEL  
(E) DILUYENTE  
(P) DISSOLVENTE  
(I) SOLVENTE  
(NL) OPLOSMIDDEL

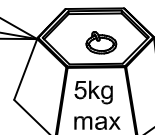
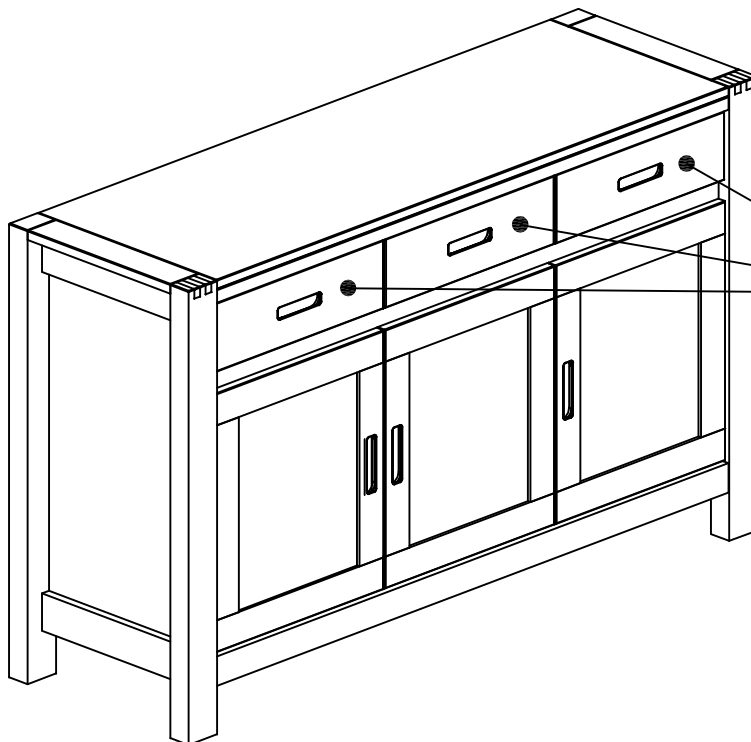

85 cm  
33 1/2"

139,6 cm  
55"

44 cm  
17 1/3"

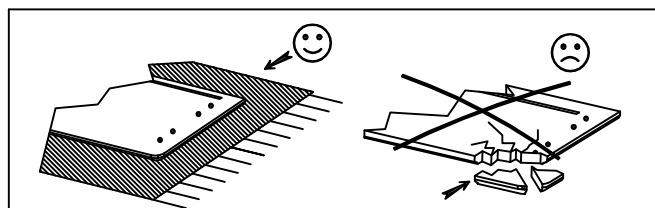

**GARDEZ CE DOCUMENT :**

POUR L'APRES-VENTE, RETOURNEZ AU MAGASIN AVEC CETTE NOTICE

(GB) PLEASE NOTIFY THE RETAILER WHERE YOU PURCHASED IT FROM, QUOTING: THE REFERENCE OF FURNITURE AND OF THE COMPONENT.

(D) WENDEN SIE SICH BITTE AN IHREN HANDLER UND GEBEN SIE IHM DIE KENNUMMER DES MOBELS UND DIE TEILNUMMER.

(E) CONSERVAR ESTE DOCUMENTO: PARA EL SERVICIO POST VENTA, VUELVA A LA TIENDA CON ESTA NOTICIA.

(P) GUARDAR ESTE DOCUMENTO : PARA DEPOIS DA VENDA, VOLTAR A LOJA COM ESTAS INSTRUÇÕES.

(I) CONSERVARE QUESTO DOCUMENTO: PER OGNI RICHIESTA DOPO ACQUISTO, TORNARE AL NEGOZIO CON QUESTO LIBRETTO.

(NL) BEWAAR DEZE HANDLEIDING GOED. IN GEVAL VAN PROBLEEM OF EVENTUELE KLACHTEN NEEM DAN DEZE HANDLEIDING, MEE NAAR DE WINKEL WAAR U DE KAST HEEFT GEKOCHT

# REPEREZ LES PIECES SUR LA "VUE ECLATEE"

- Ⓒ LOCATE THE PIECES ON THE "CROSS SECTION"
- Ⓓ IDENTIFIZIEREN SIE DIE TEILE AN HAND DER "PERSPEKTIVISCHEN DARSTELLUNG"
- Ⓔ LOCALIZACION DE LAS PIEZAS
- Ⓕ ENCONTRAR AS PECAS NA "VISTA REBINTADA"
- Ⓖ INDIVIDUARE OGNI PEZZO SULLA "VUE ECLATEE"
- Ⓝ PLAATS DE STUKKEN VOLGENS HUN "LOSSE OBSTELLING"

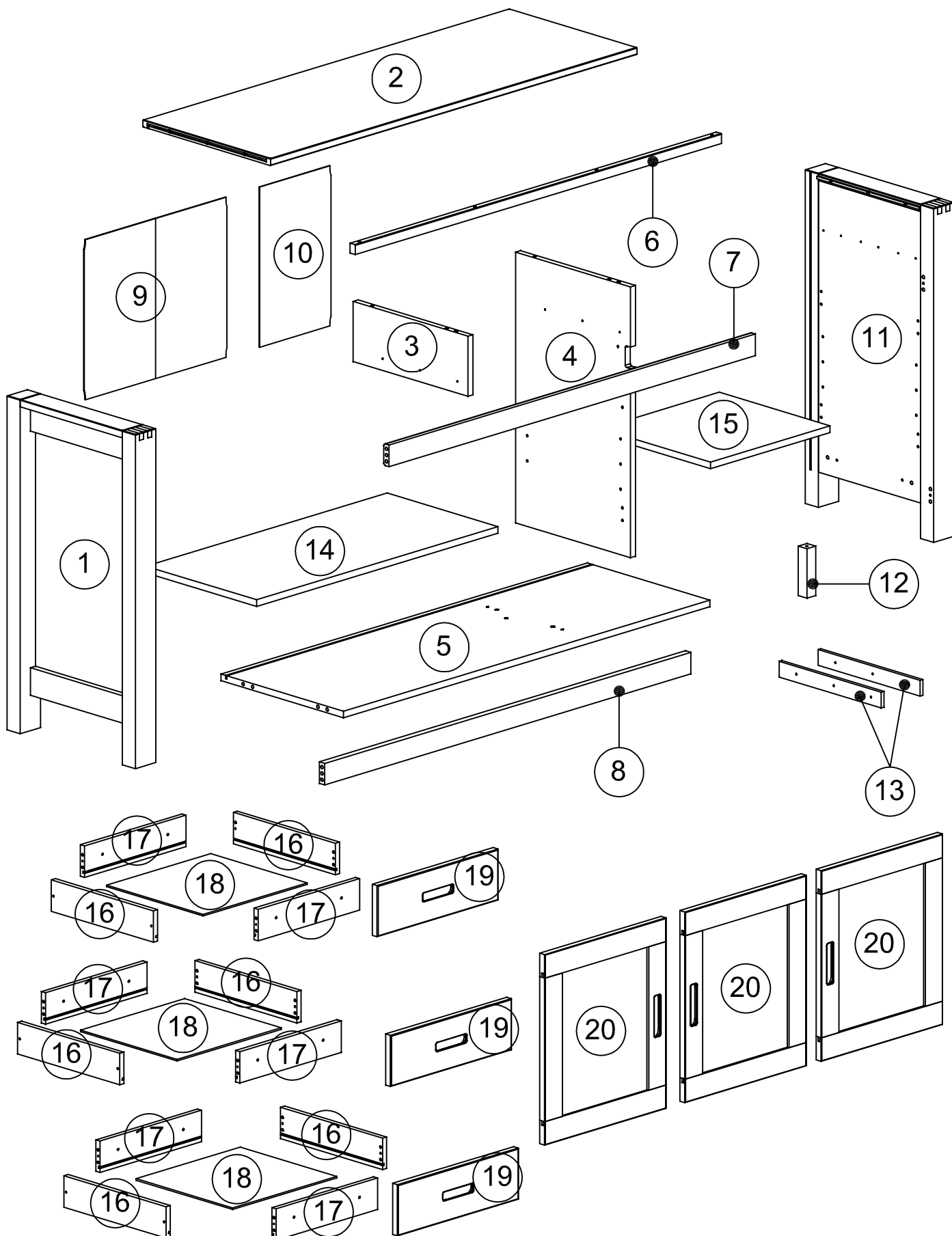

# LISTE QUINCAILLERIE

- (GB) LIST OF COMPONENTS
- (D) BESCHLAGE
- (E) LISTA DE HERRAJES
- (P) LISTA DE FERRAGENS
- (I) LISTA CHINCAGLIERIA
- (NL) LIJST VAN TOEBEHOREN

REPERE DE LA QUINCAILLERIE  
COMPONENT REFERENCE NUMBER  
TEIL REFERENZ  
CODIFICACION DE LOS HERRAJES  
REFERENCIA DA FERRAGEN  
RIFERIMENTO DELLA CHINCAGLIERIA  
CONTROLE VAN HET TOEBEHOREN

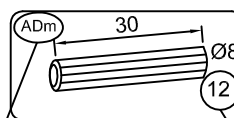

QUANTITE UTILISEE  
NUMBER OF PIECES  
GEBRAUCHTE MENGE  
CANTIDAD UTILIZADA  
QUANTIDADE UTILISADA  
QUANTITA UTILIZZATA  
GEBRUIKTE HOEVEELHEID

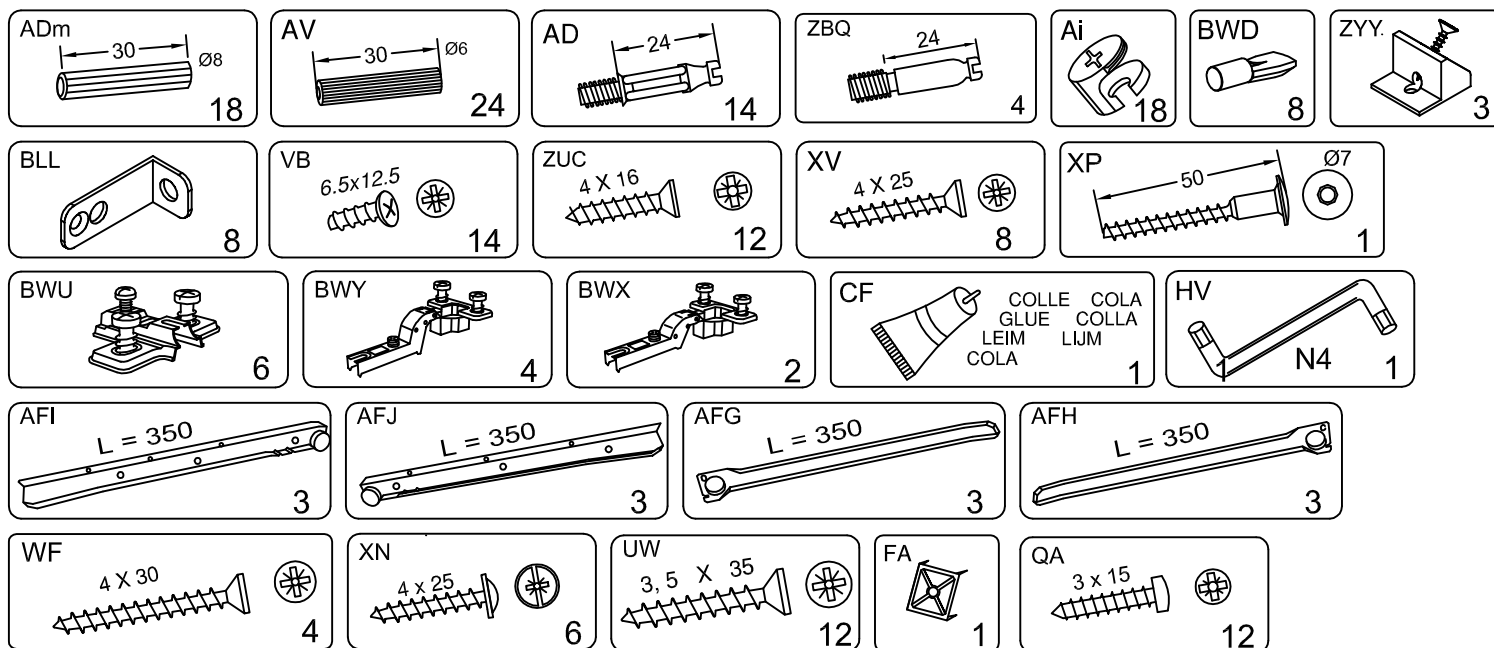

## PHASE

1

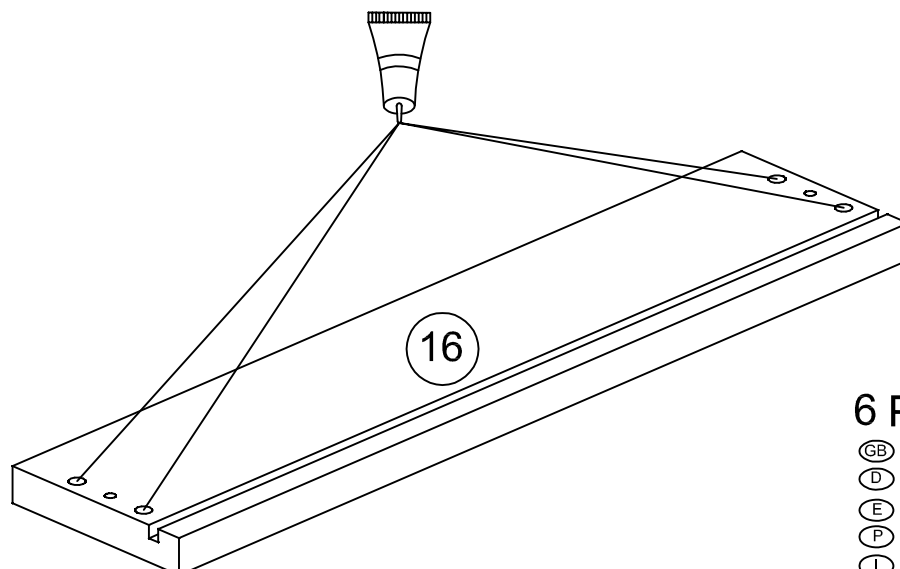
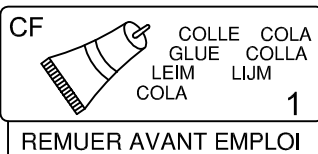

## 6 PIECES

- (GB) 6 PARTS
- (D) 6 STÜCKEN
- (E) 6 PIEZAS
- (P) 6 PECAS
- (I) 6 PEZZI
- (NL) 6 STUKS



PHASE

2

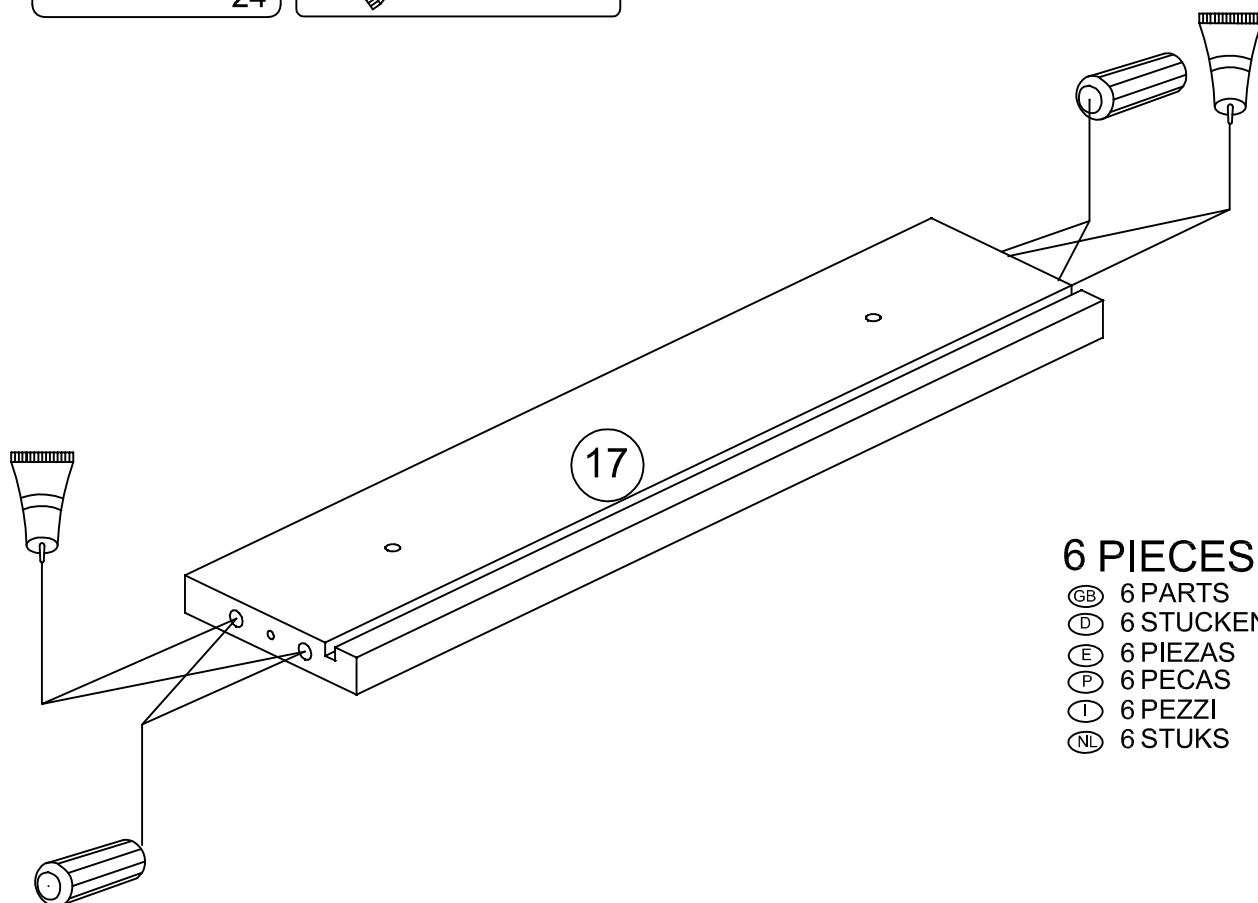
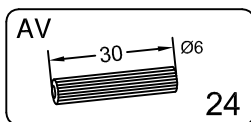

6 PIECES

- Ⓔ 6 PARTS
- Ⓓ 6 STUCKEN
- Ⓔ 6 PIEZAS
- Ⓔ 6 PECAS
- Ⓓ 6 PEZZI
- Ⓓ 6 STUKS

PHASE

3

3 PIECES

- Ⓔ 3 PARTS
- Ⓓ 3 STUCKEN
- Ⓔ 3 PIEZAS
- Ⓔ 3 PECAS
- Ⓓ 3 PEZZI
- Ⓓ 3 STUKS

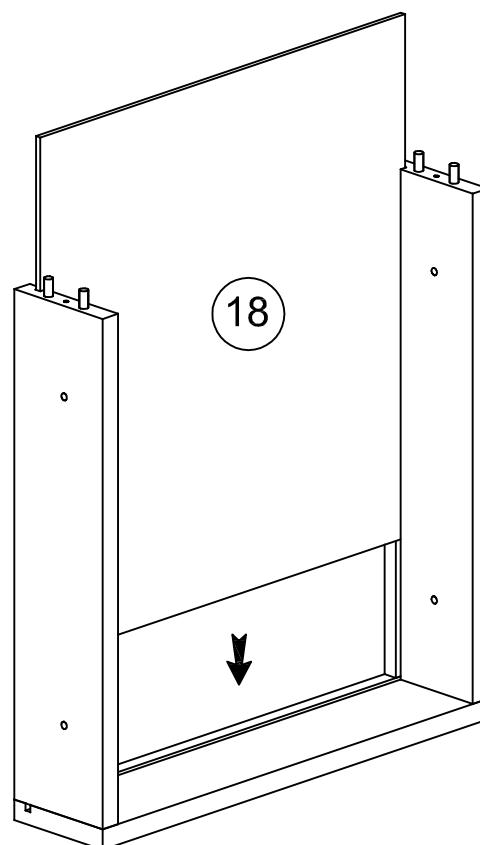
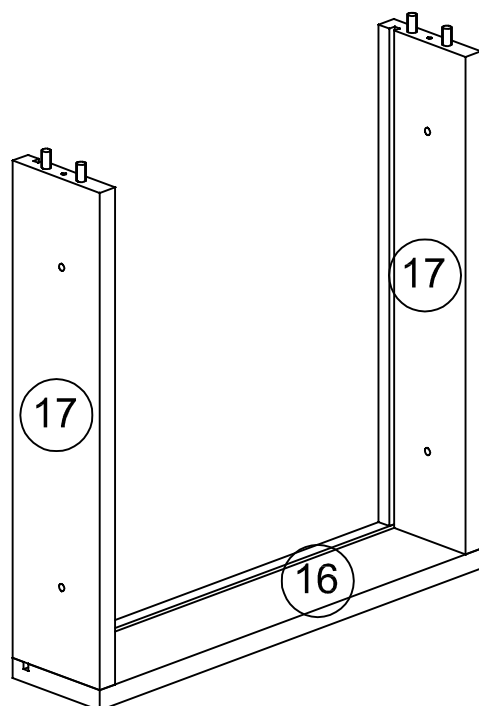

PHASE

4

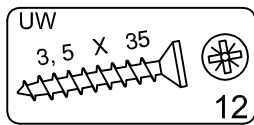

3 PIECES

- (GB) 3 PARTS
- (D) 3 STUCKEN
- (E) 3 PIEZAS
- (P) 3 PECAS
- (I) 3 PEZZI
- (NL) 3 STUKS

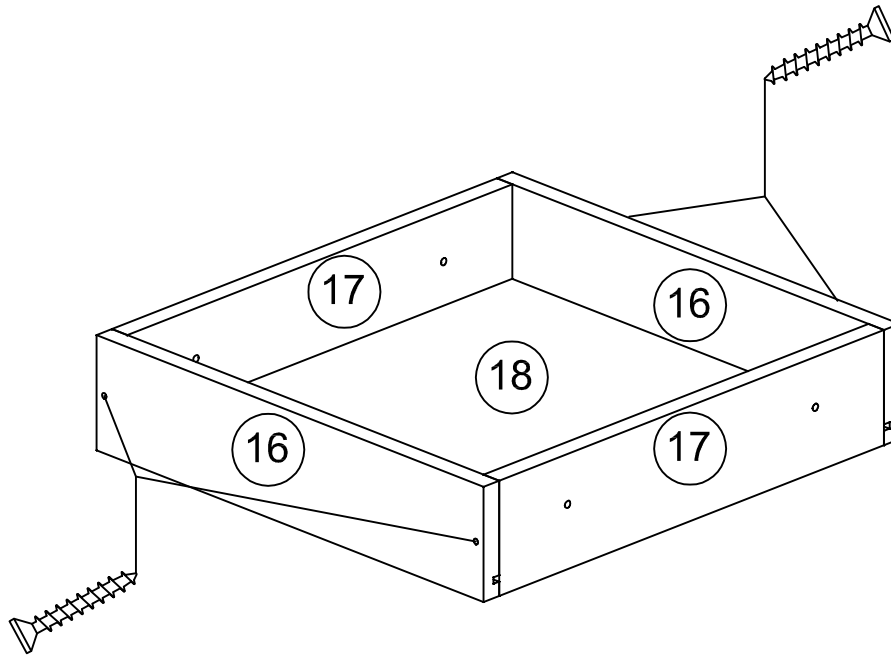

PHASE

5

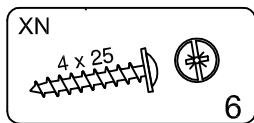

3 PIECES

- (GB) 3 PARTS
- (D) 3
- (E) 3 PIEZAS
- (P) 3 PECAS
- (I) 3 PEZZI
- (NL) 3 STUKS

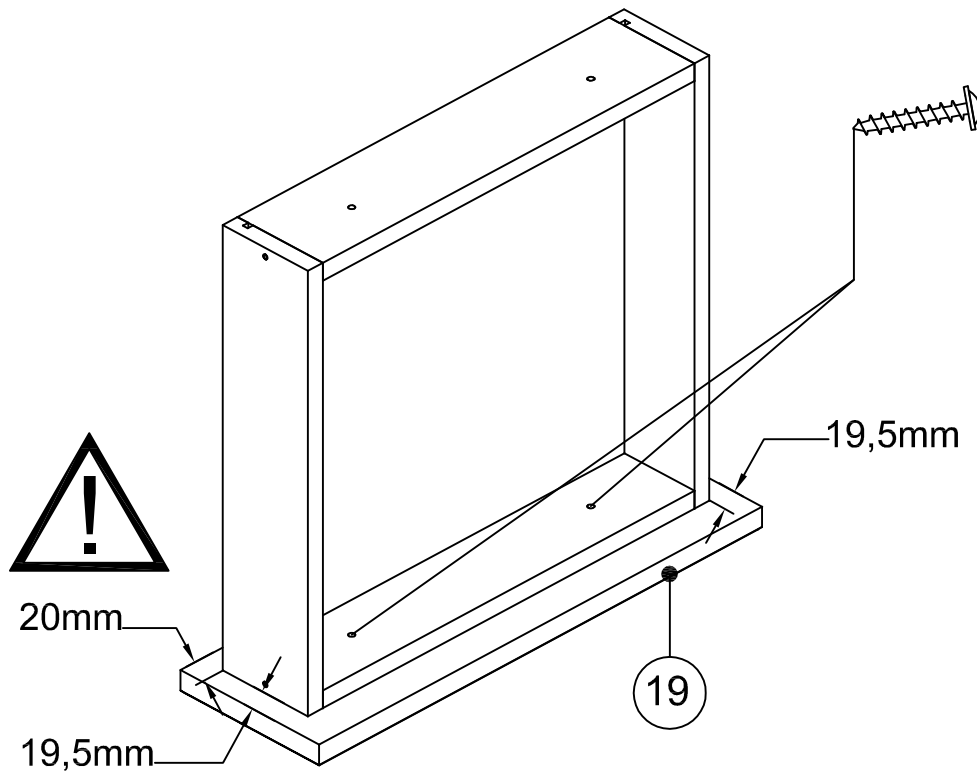

PHASE

6

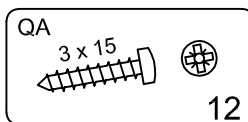
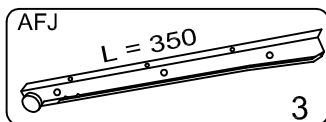
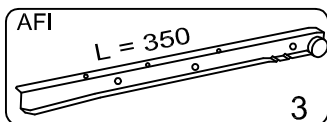

3 PIECES

- GB 3 PARTS
- D 3 STÜCKEN
- E 3 PIEZAS
- P 3 PECAS
- I 3 PEZZI
- NL 3 STUKS

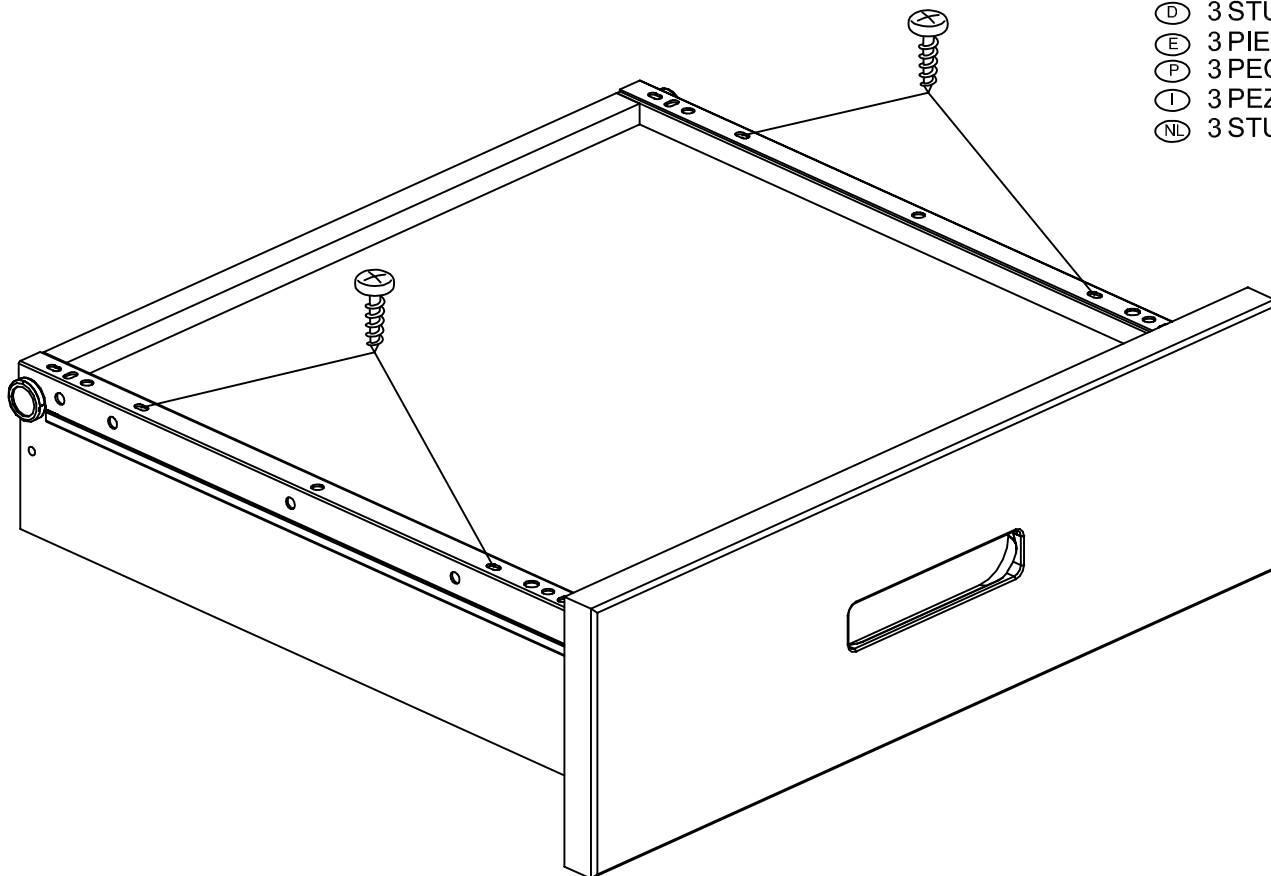

PHASE

7

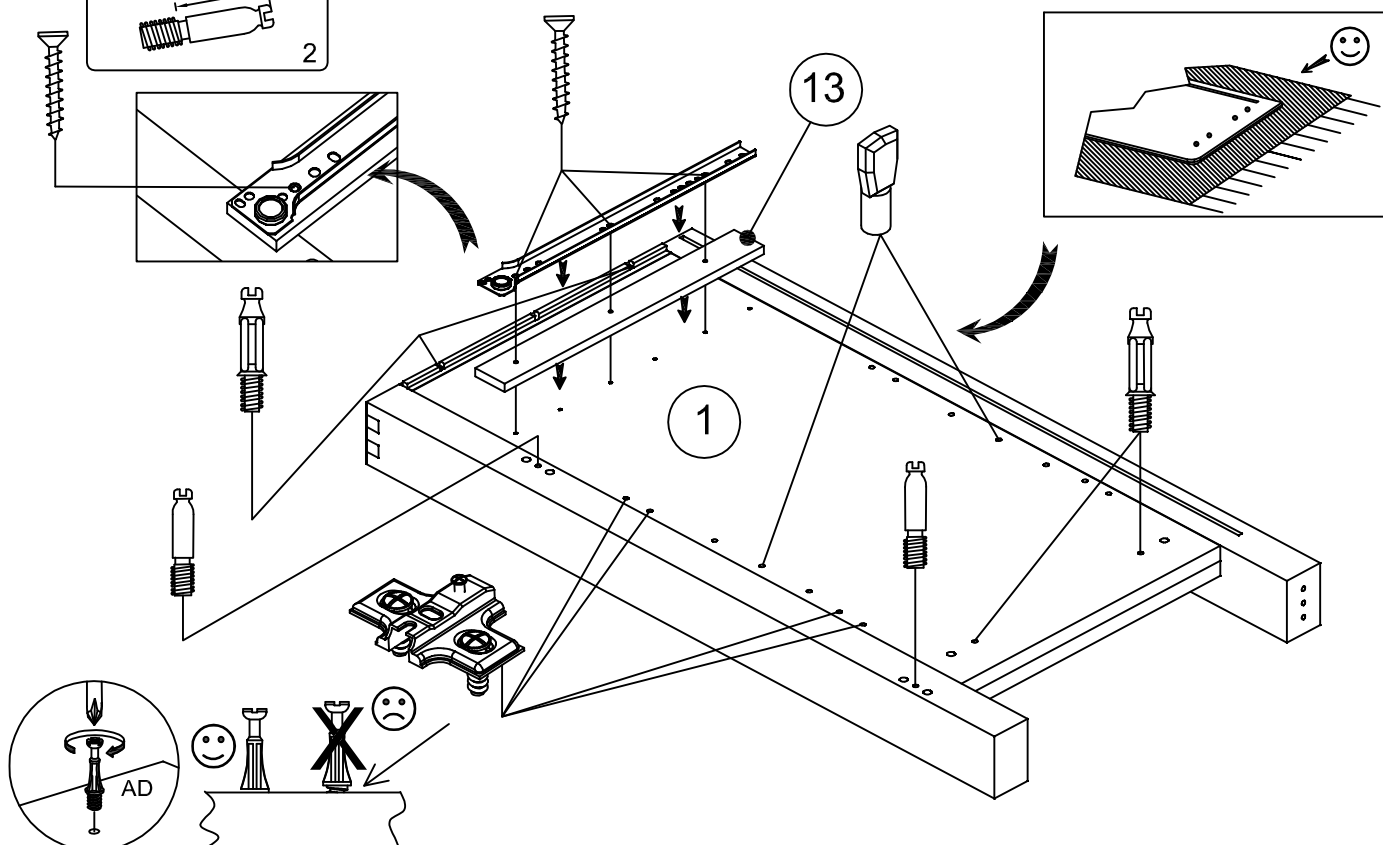
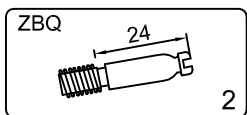
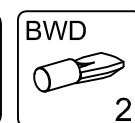
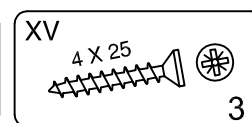
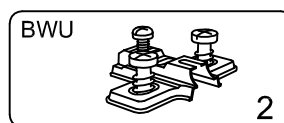
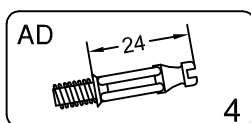
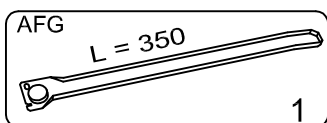

PHASE

8

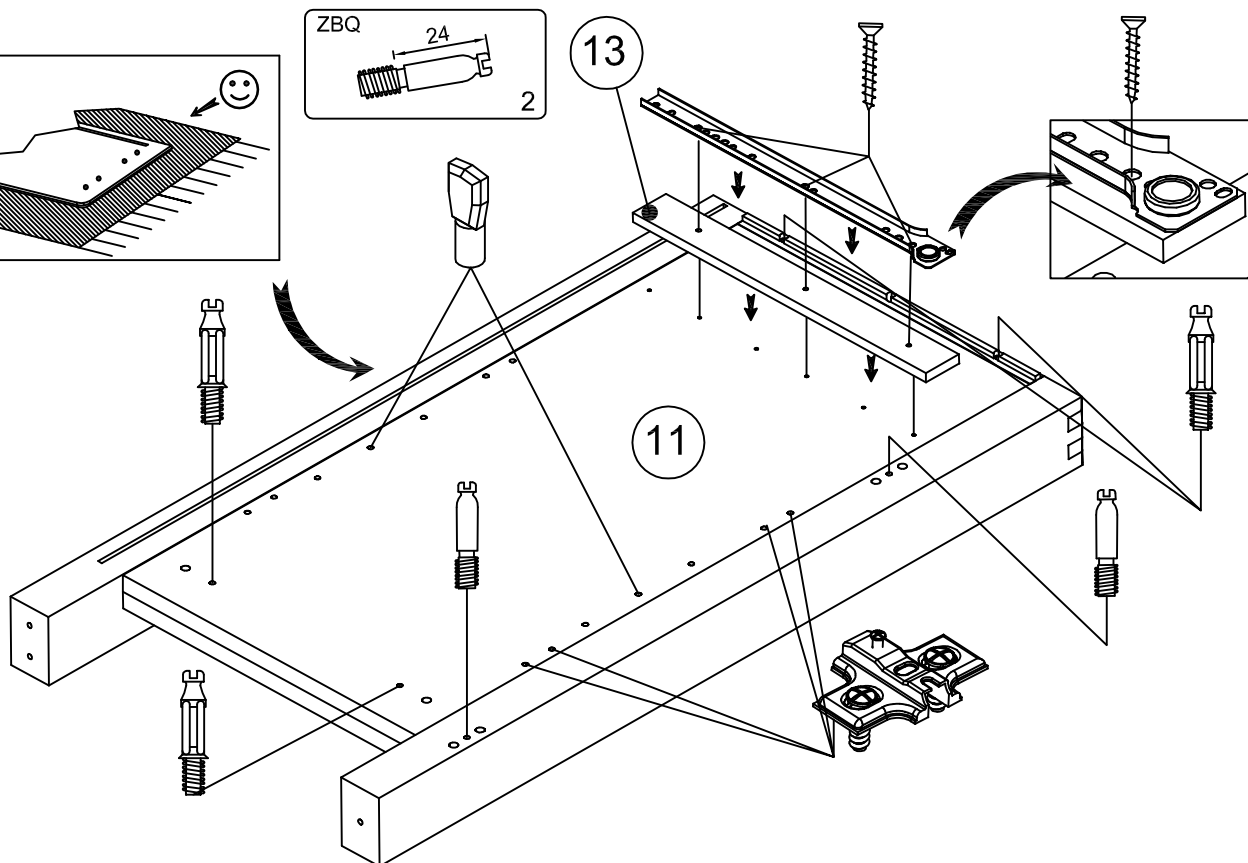
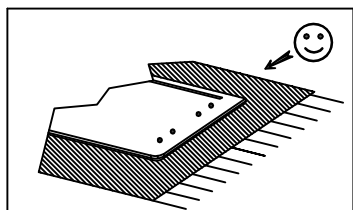
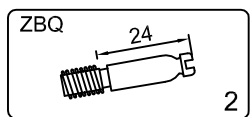
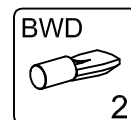
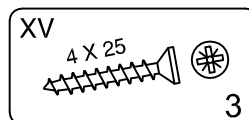
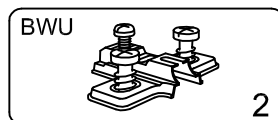
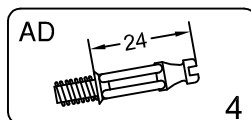
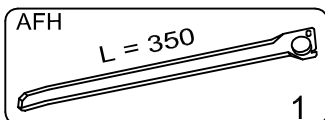

PHASE

9

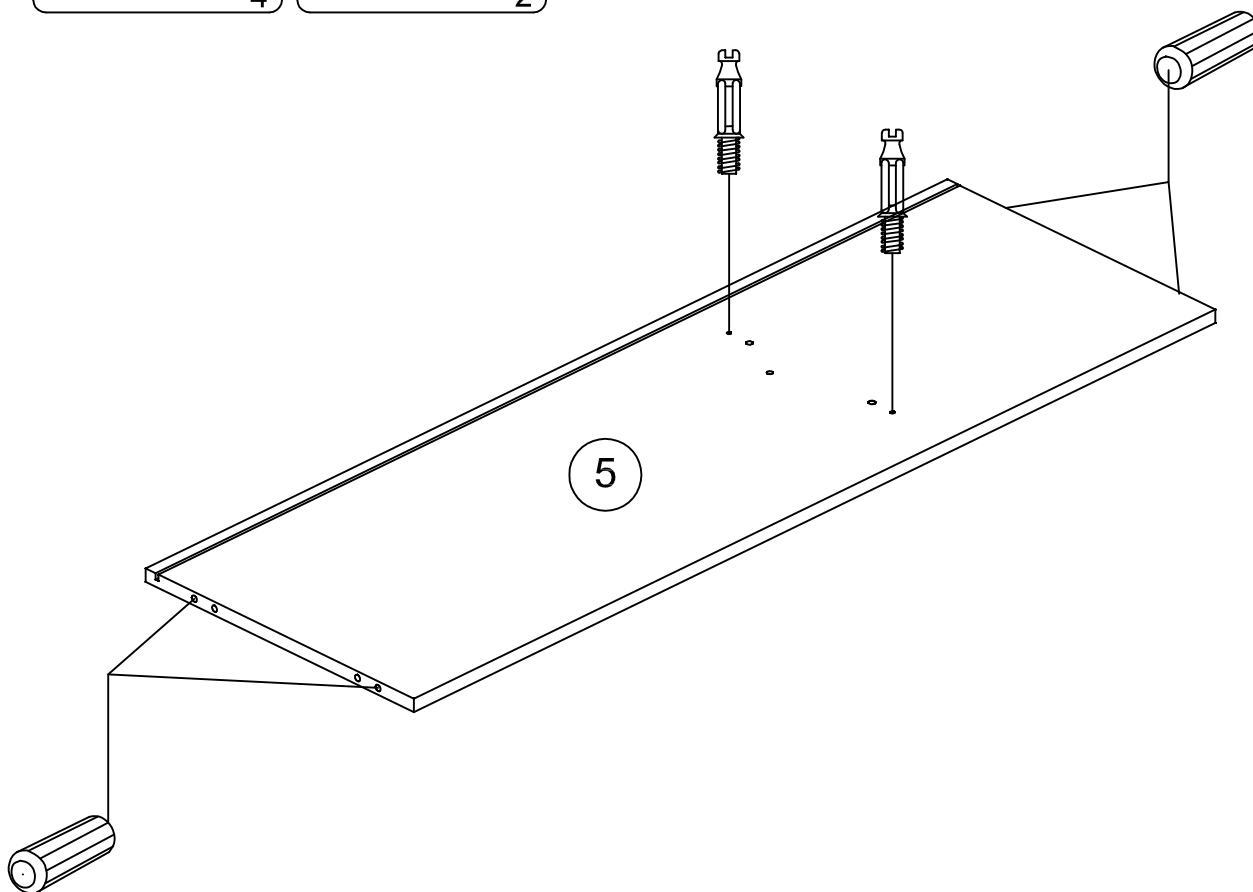
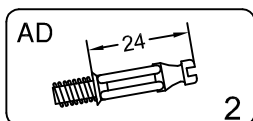
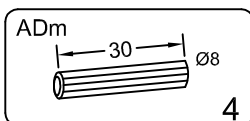

PHASE

10

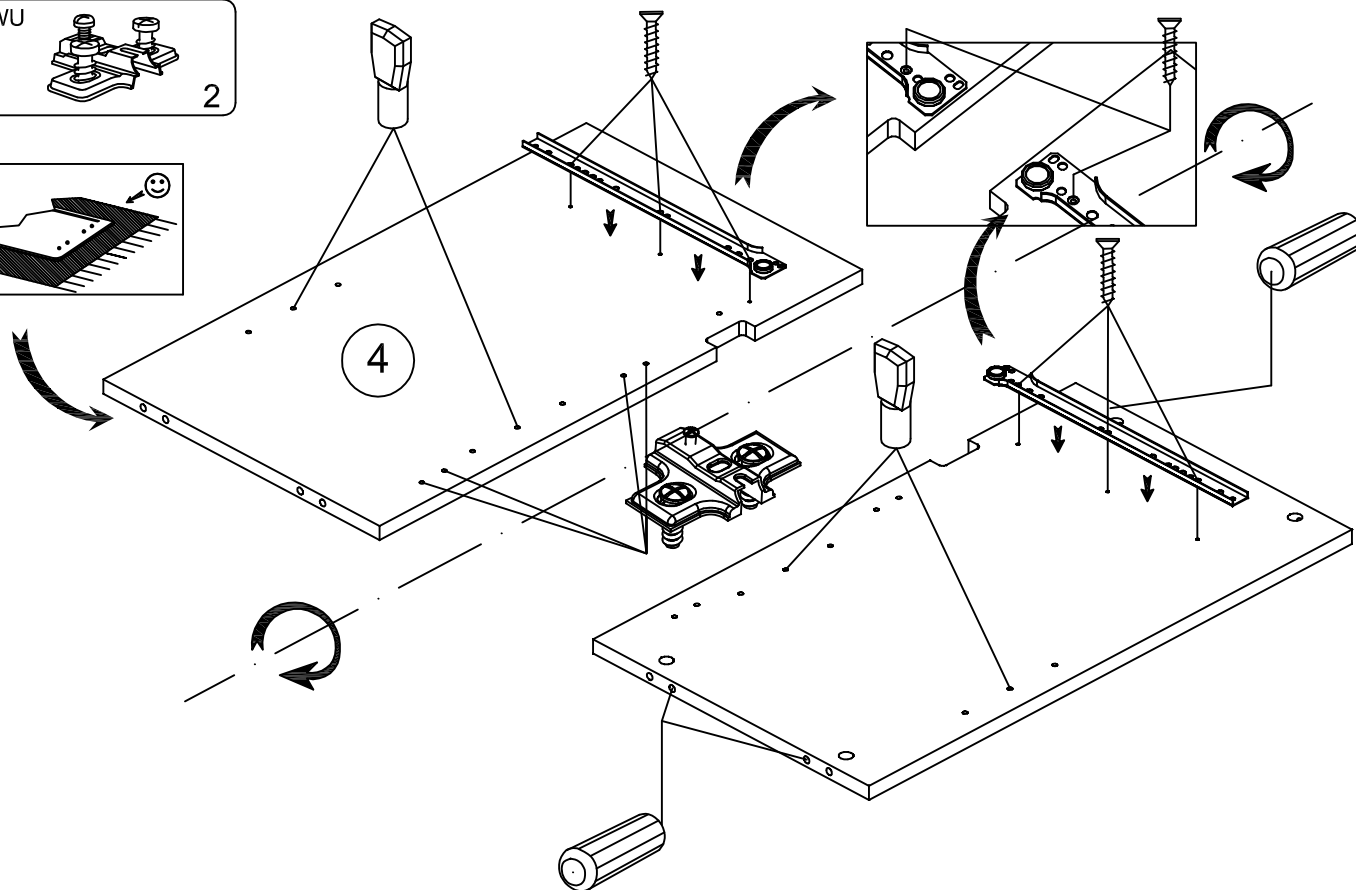
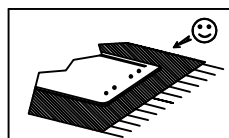
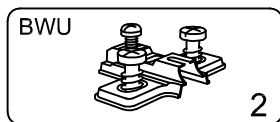
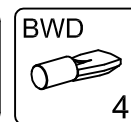
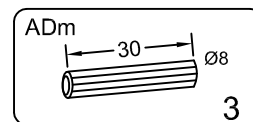
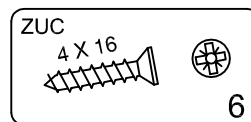
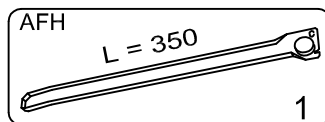
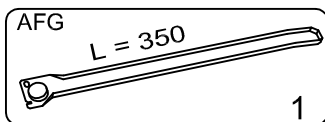

PHASE

11

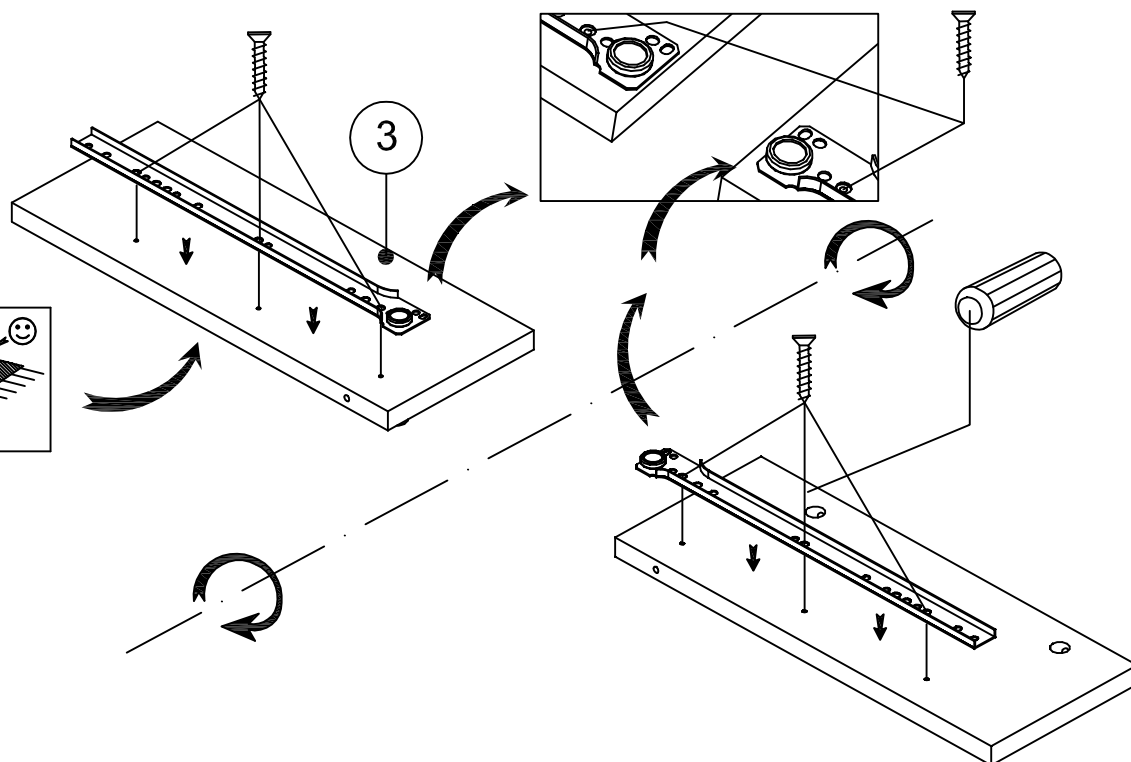
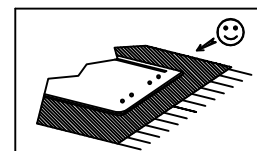
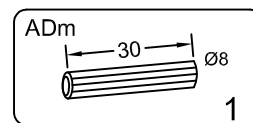
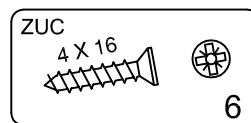
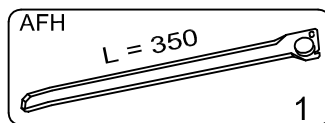
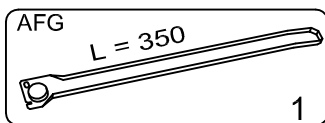



PHASE

12

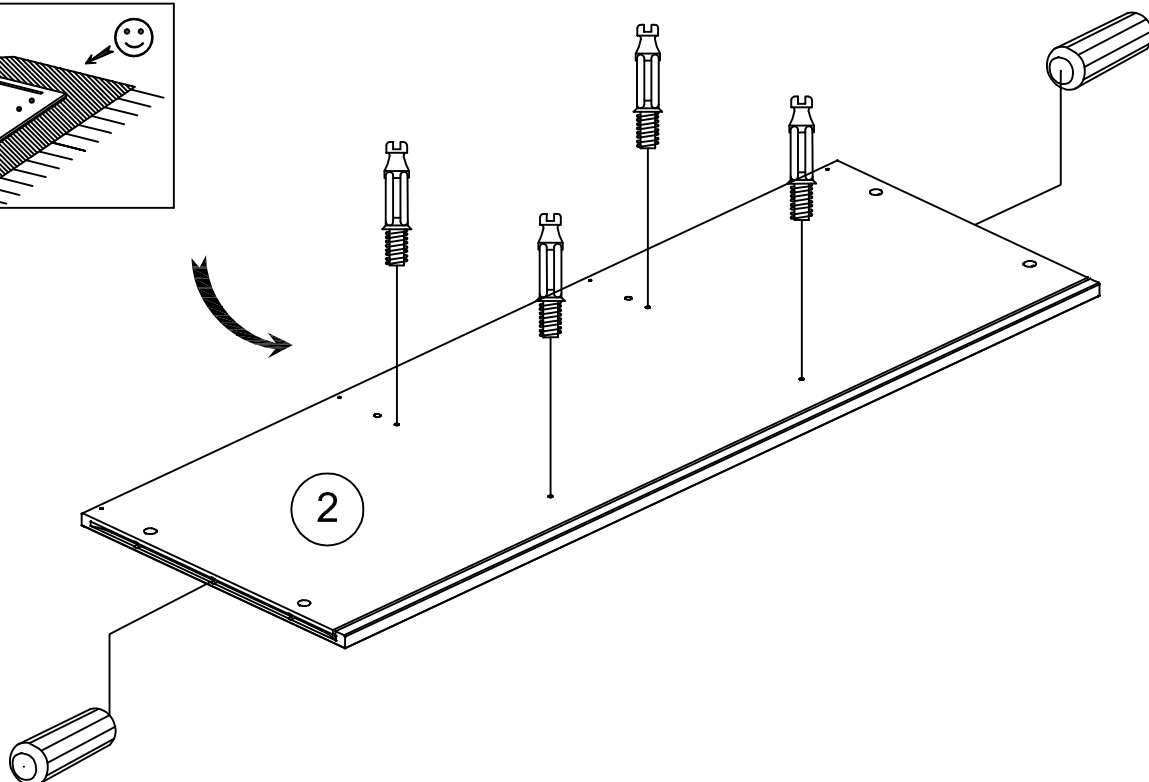
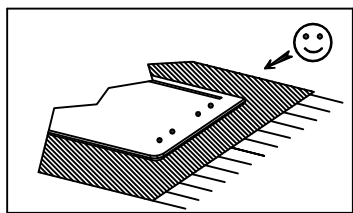
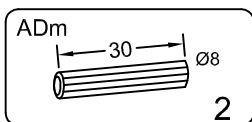
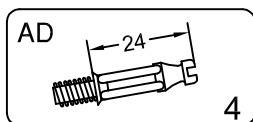

PHASE

13

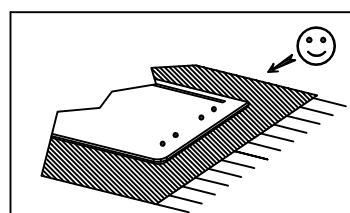
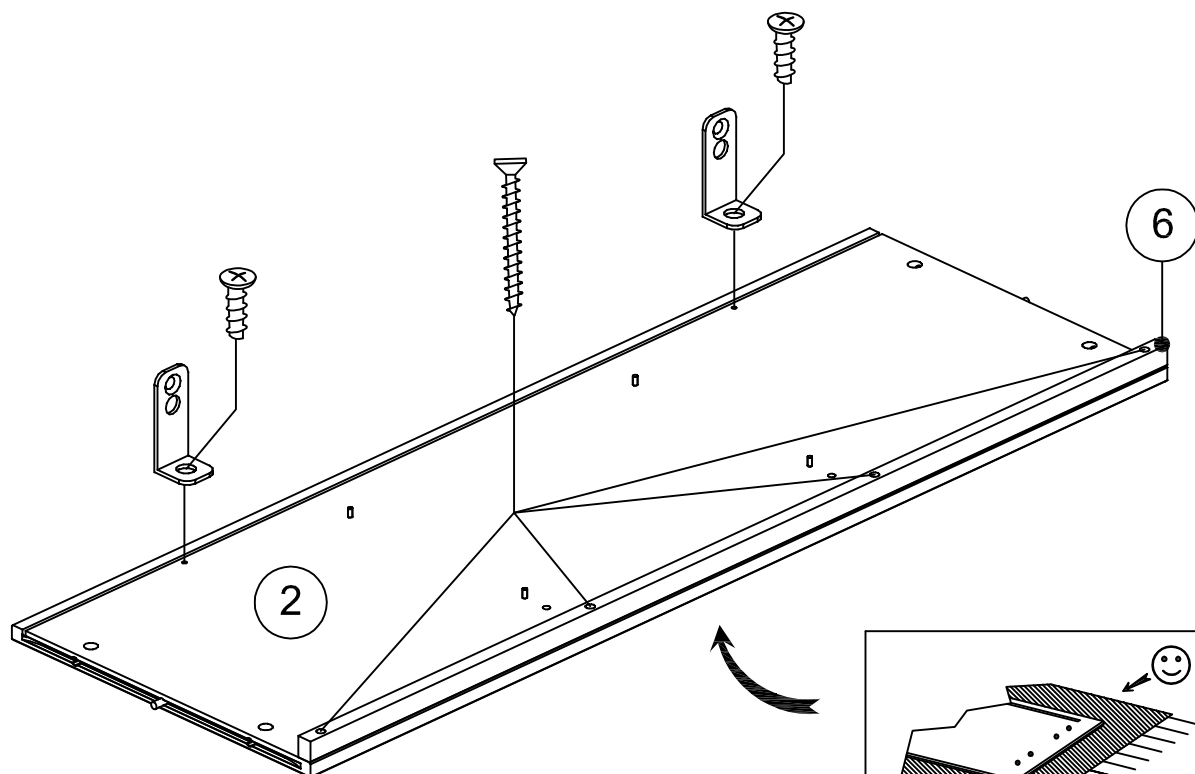
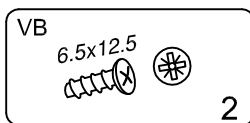
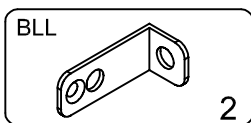
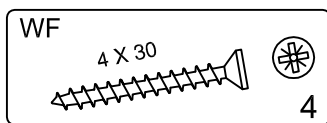

PHASE

14

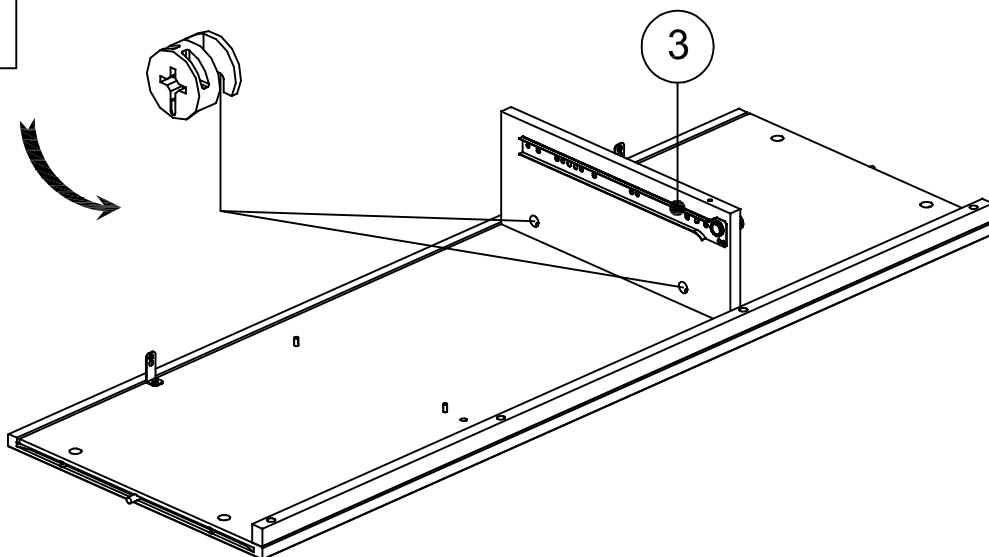
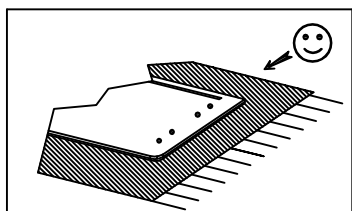
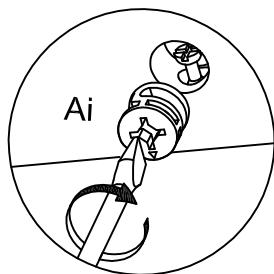
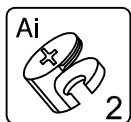

PHASE

15

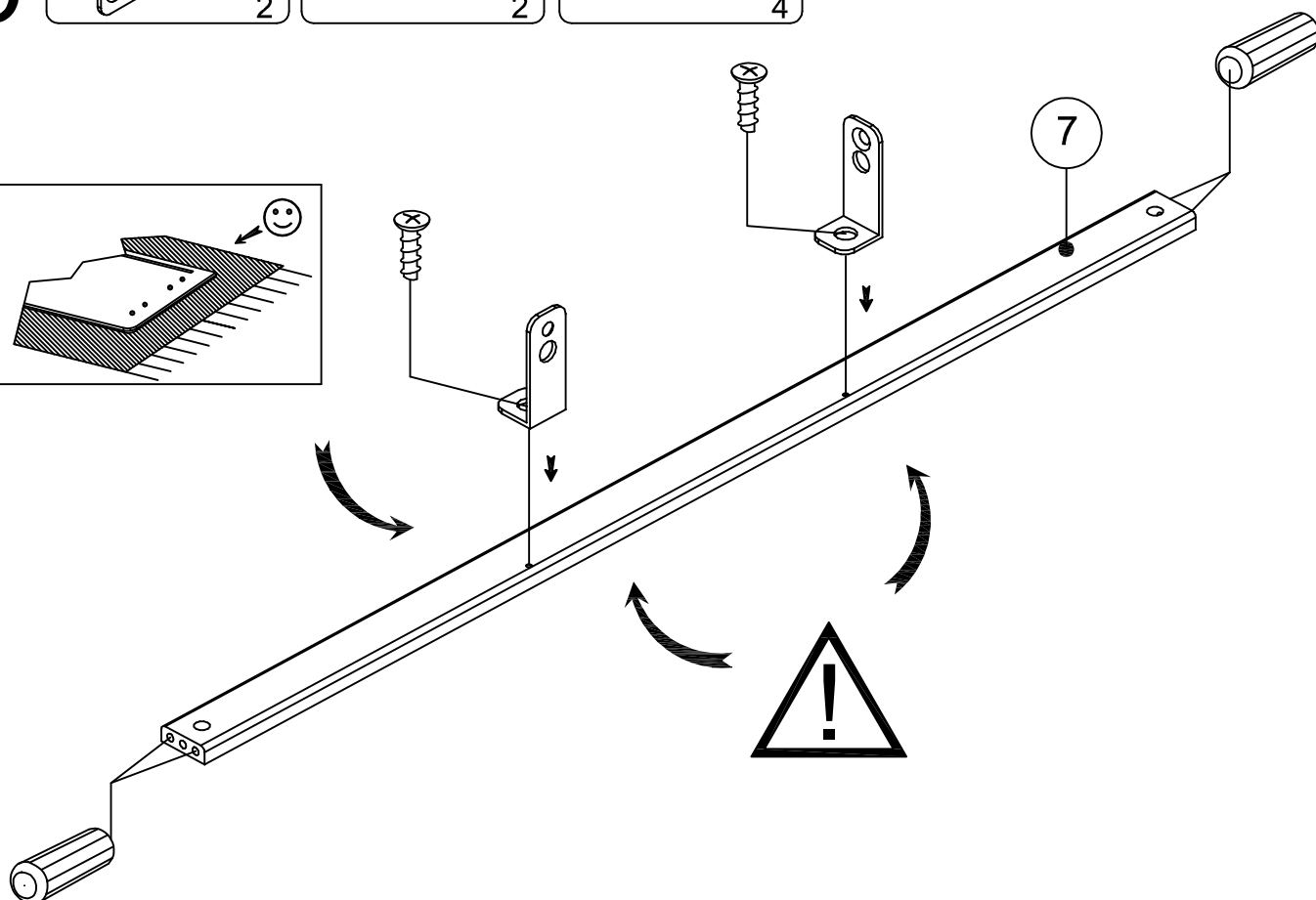
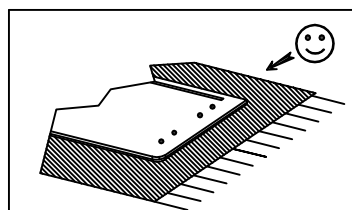
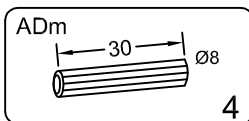
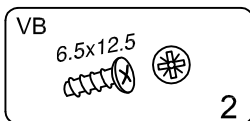
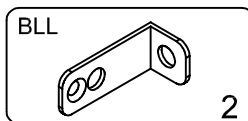

PHASE

16

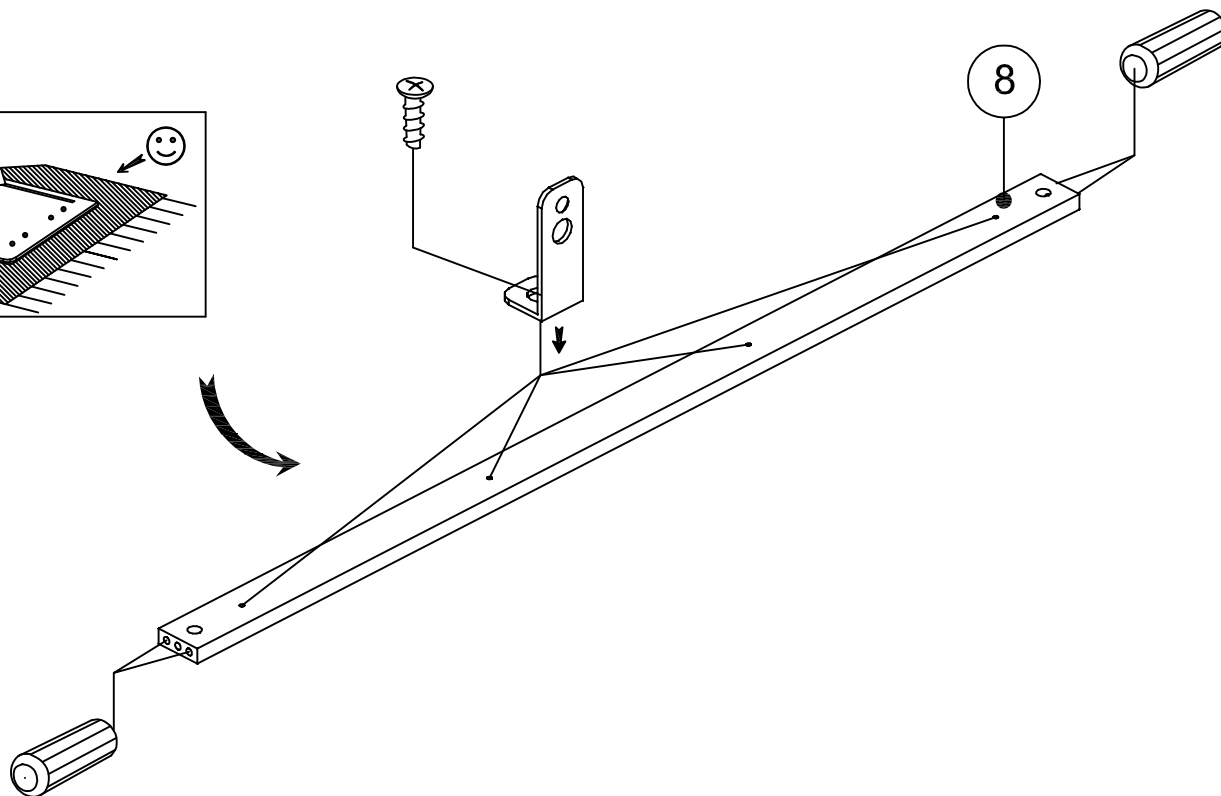
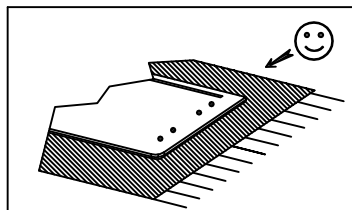
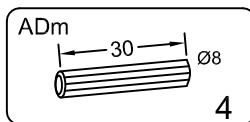
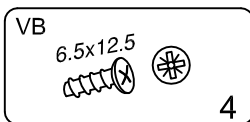
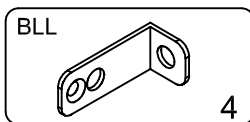

PHASE

17

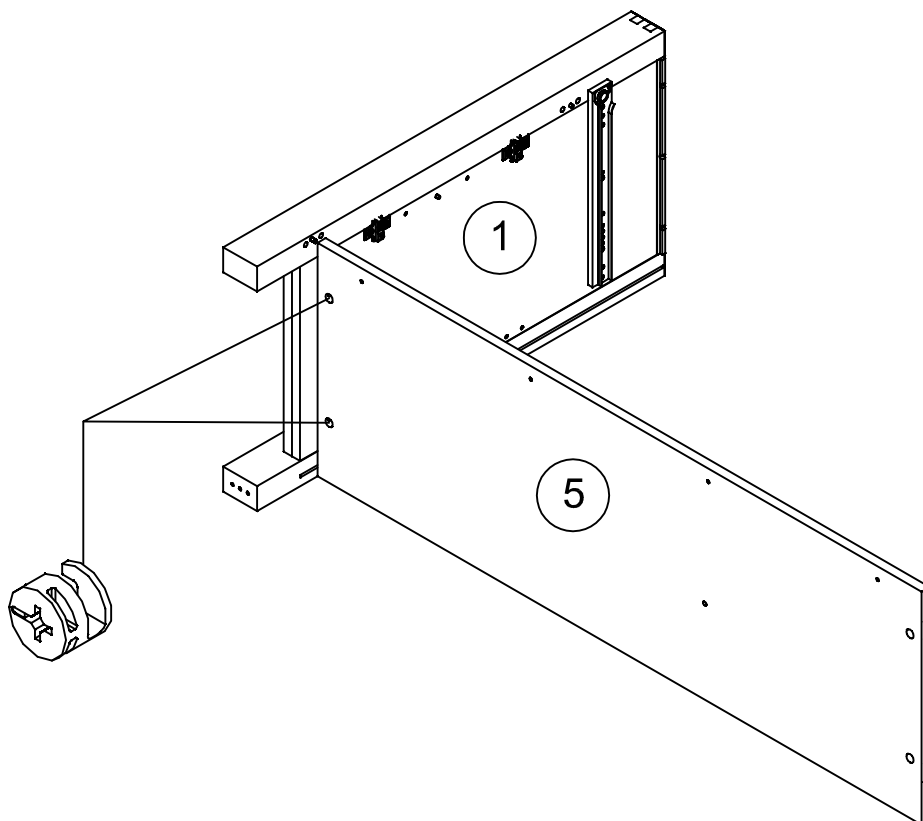
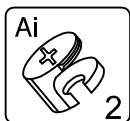

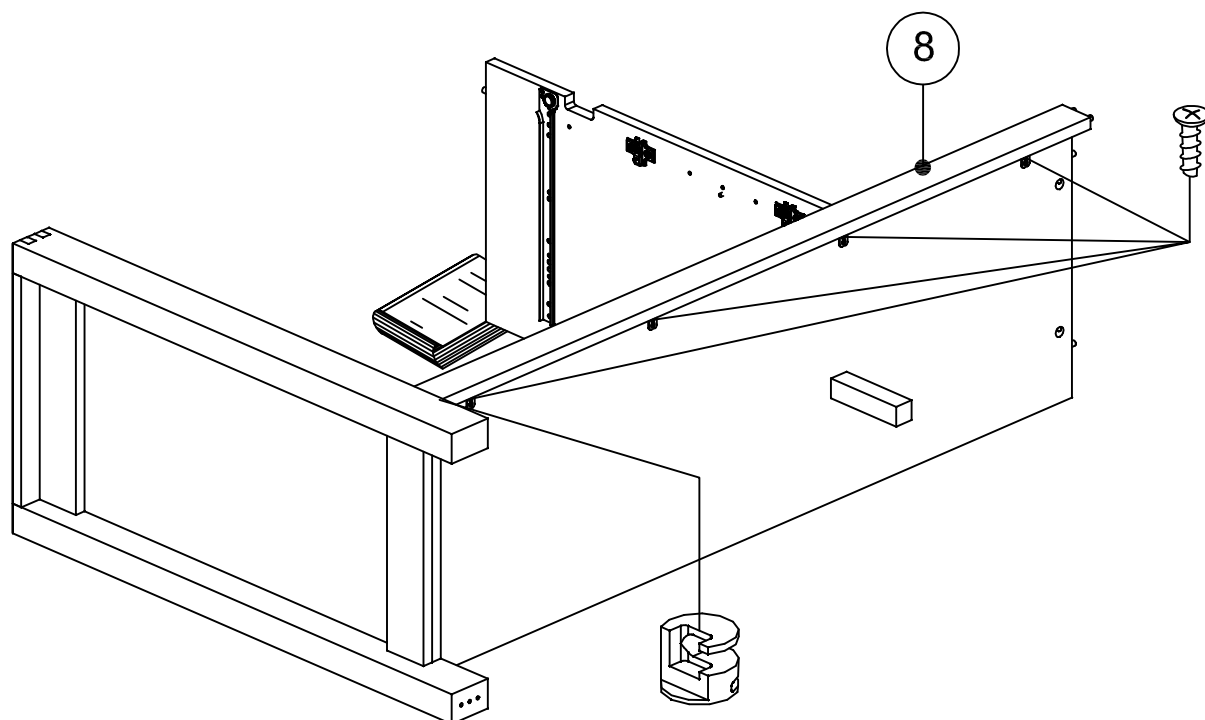
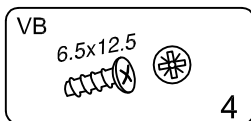
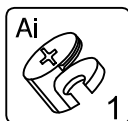
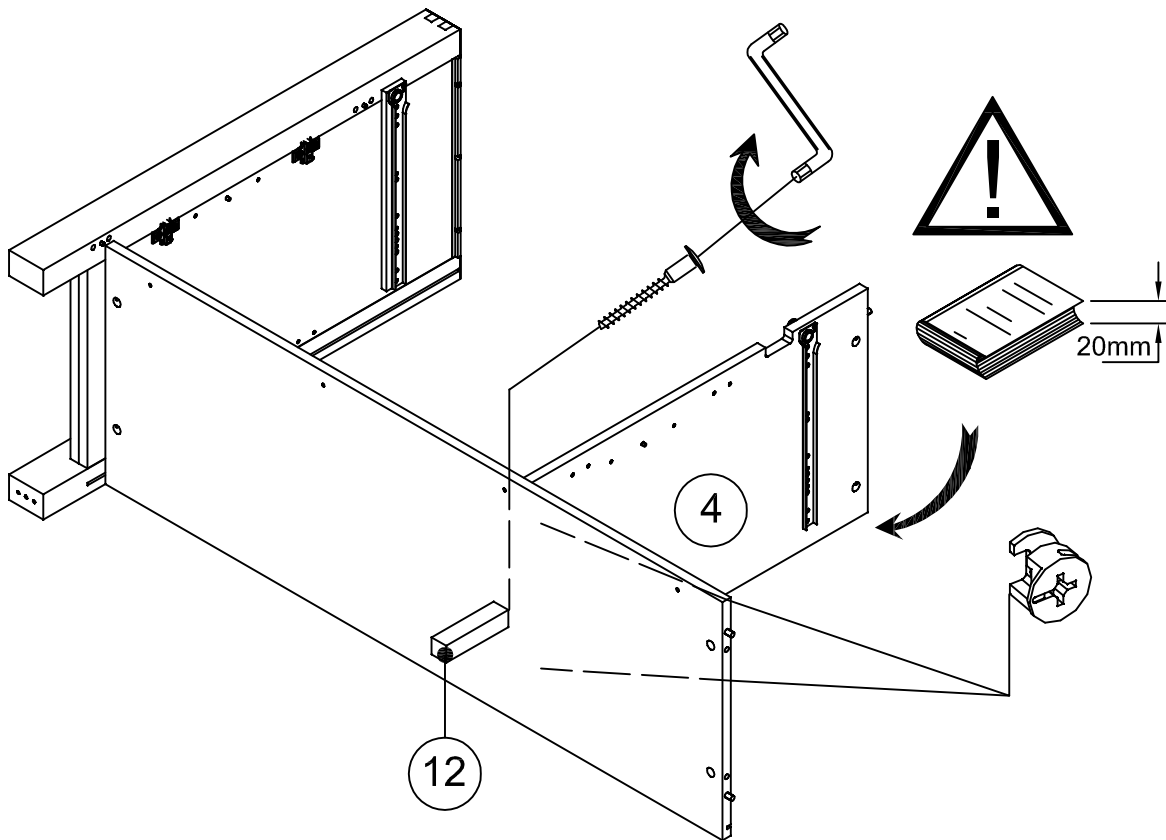
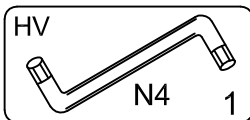
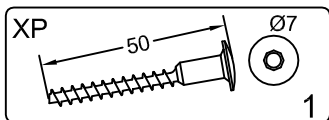
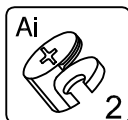

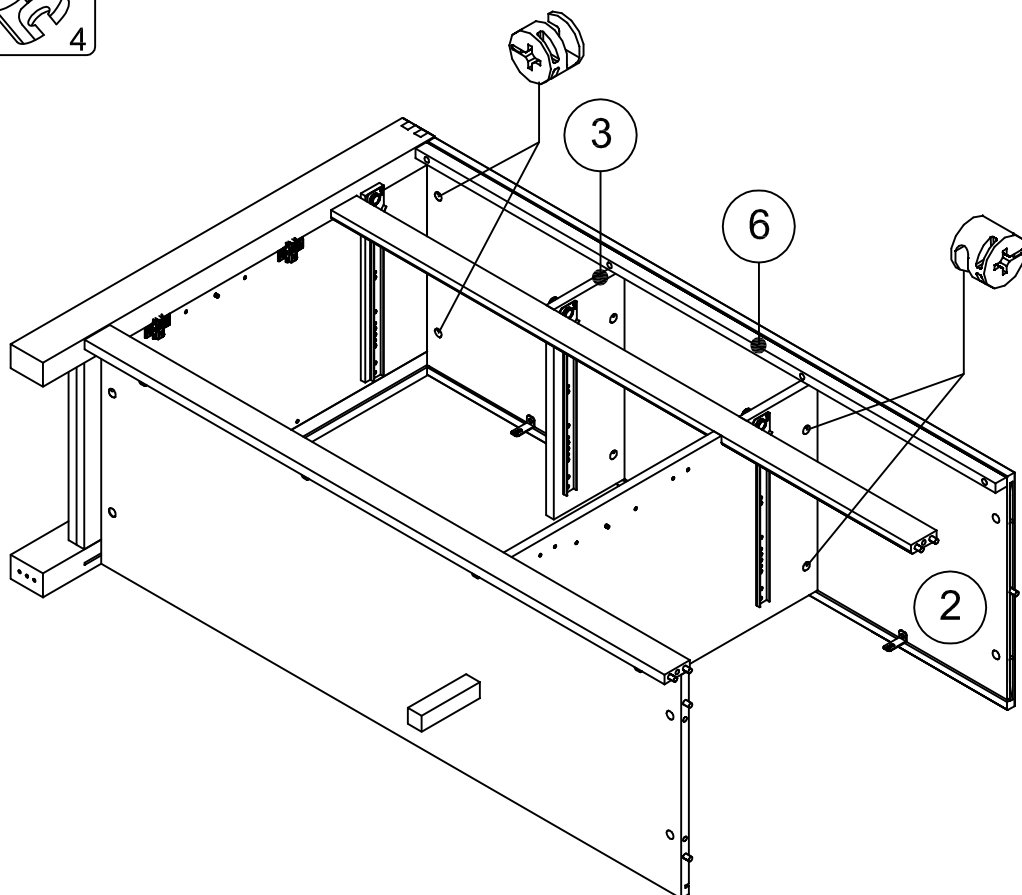
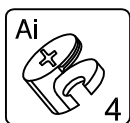
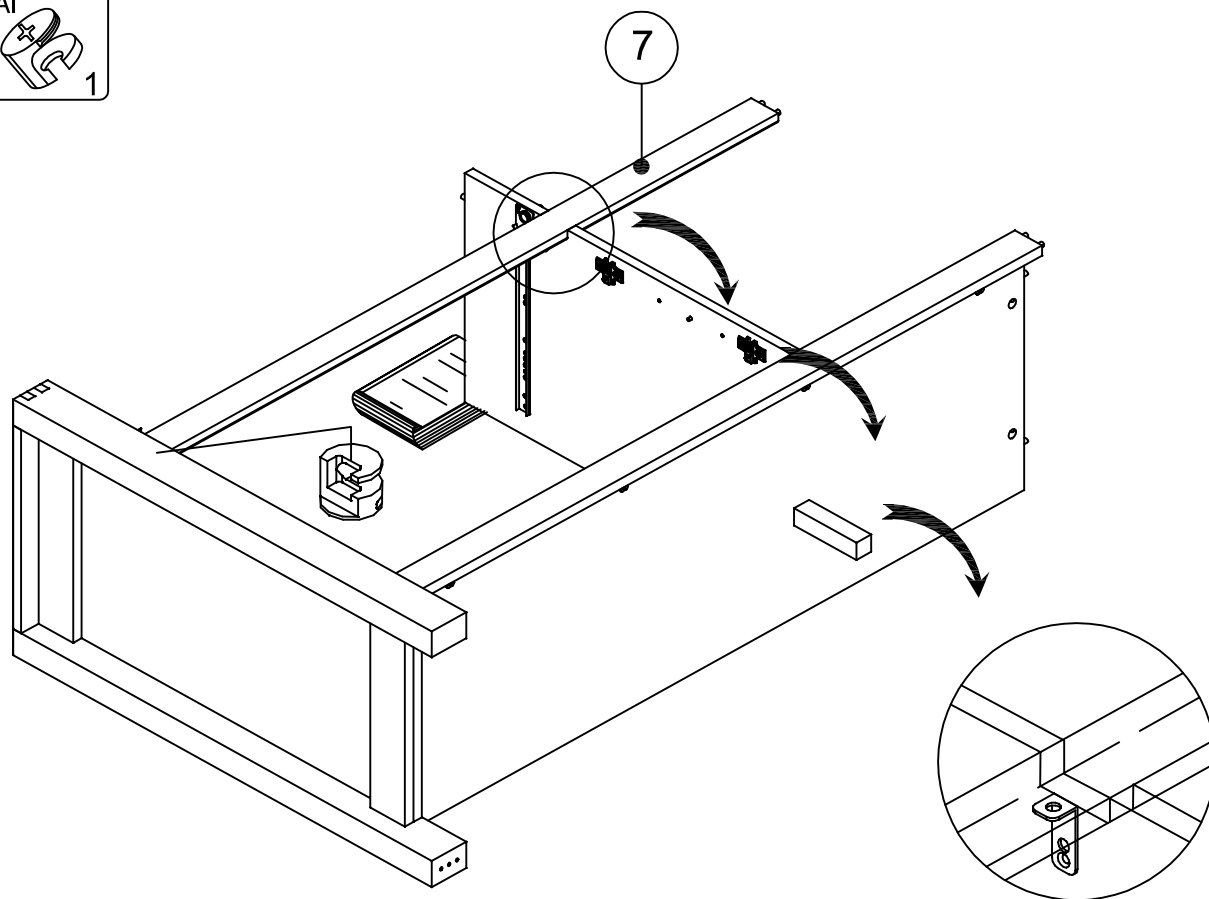
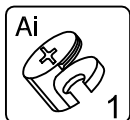

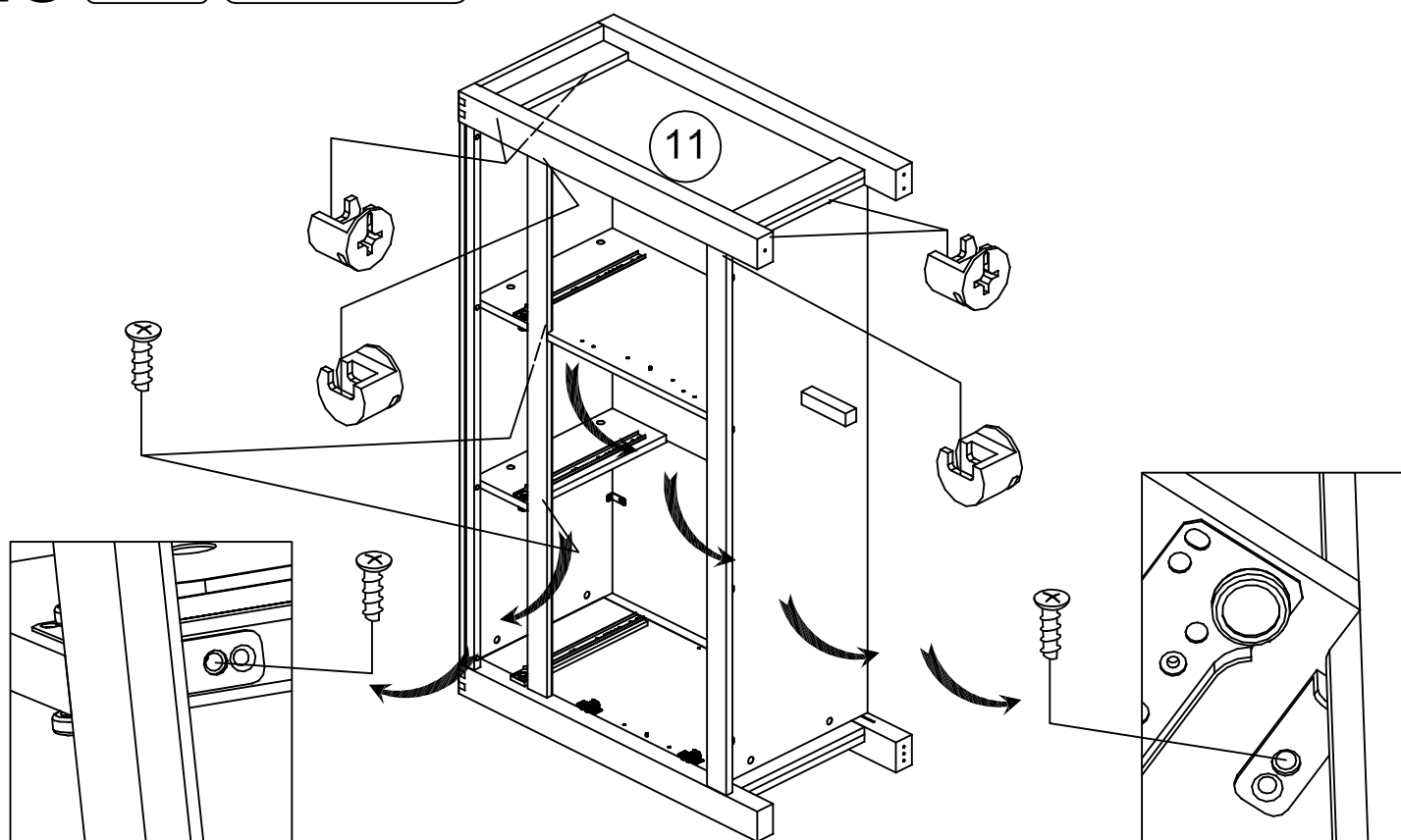
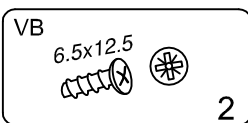
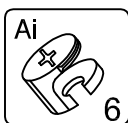
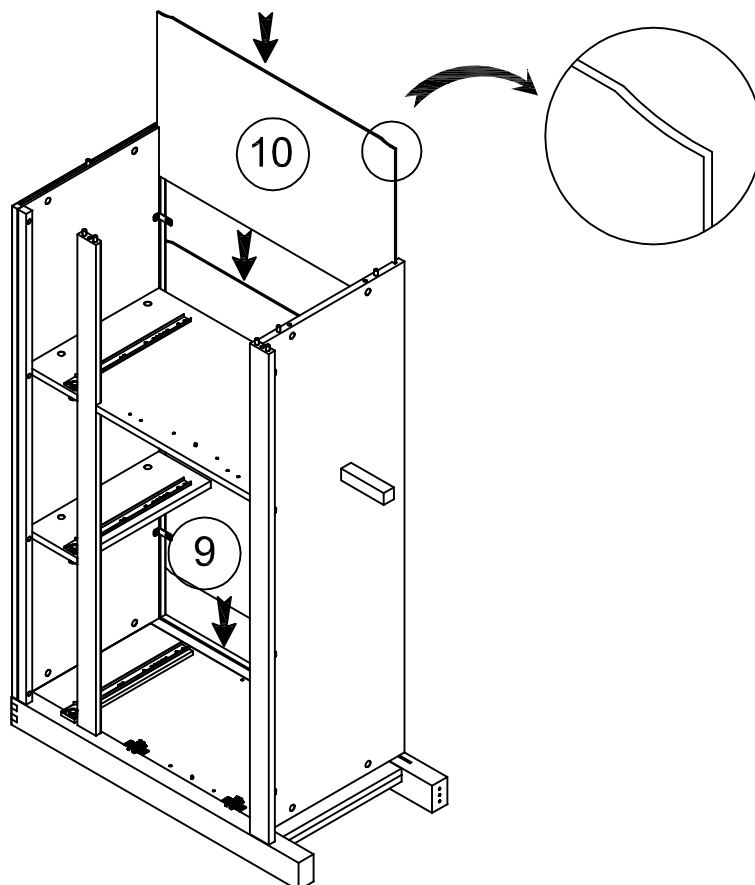

PHASE

24

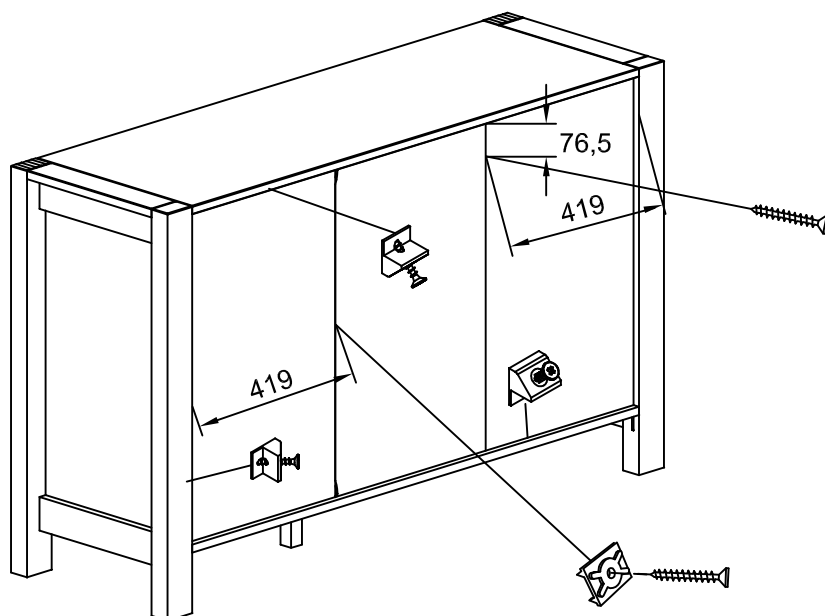
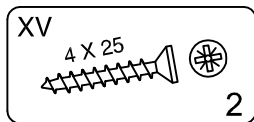
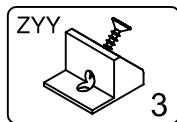
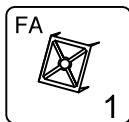

PHASE

25

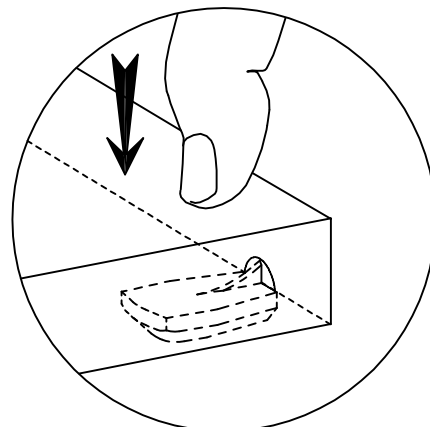
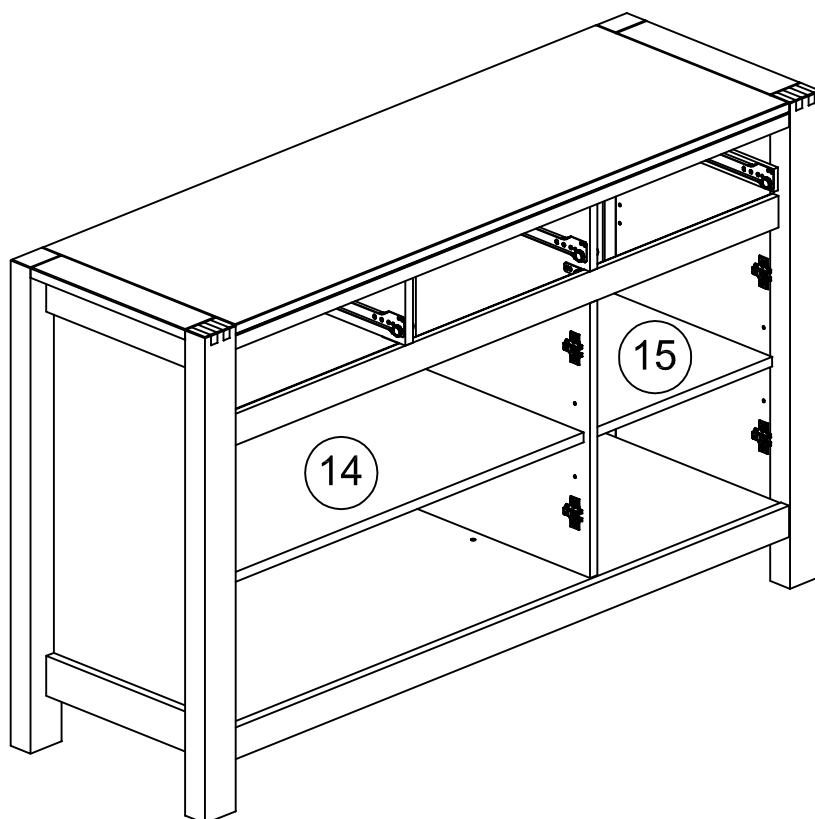

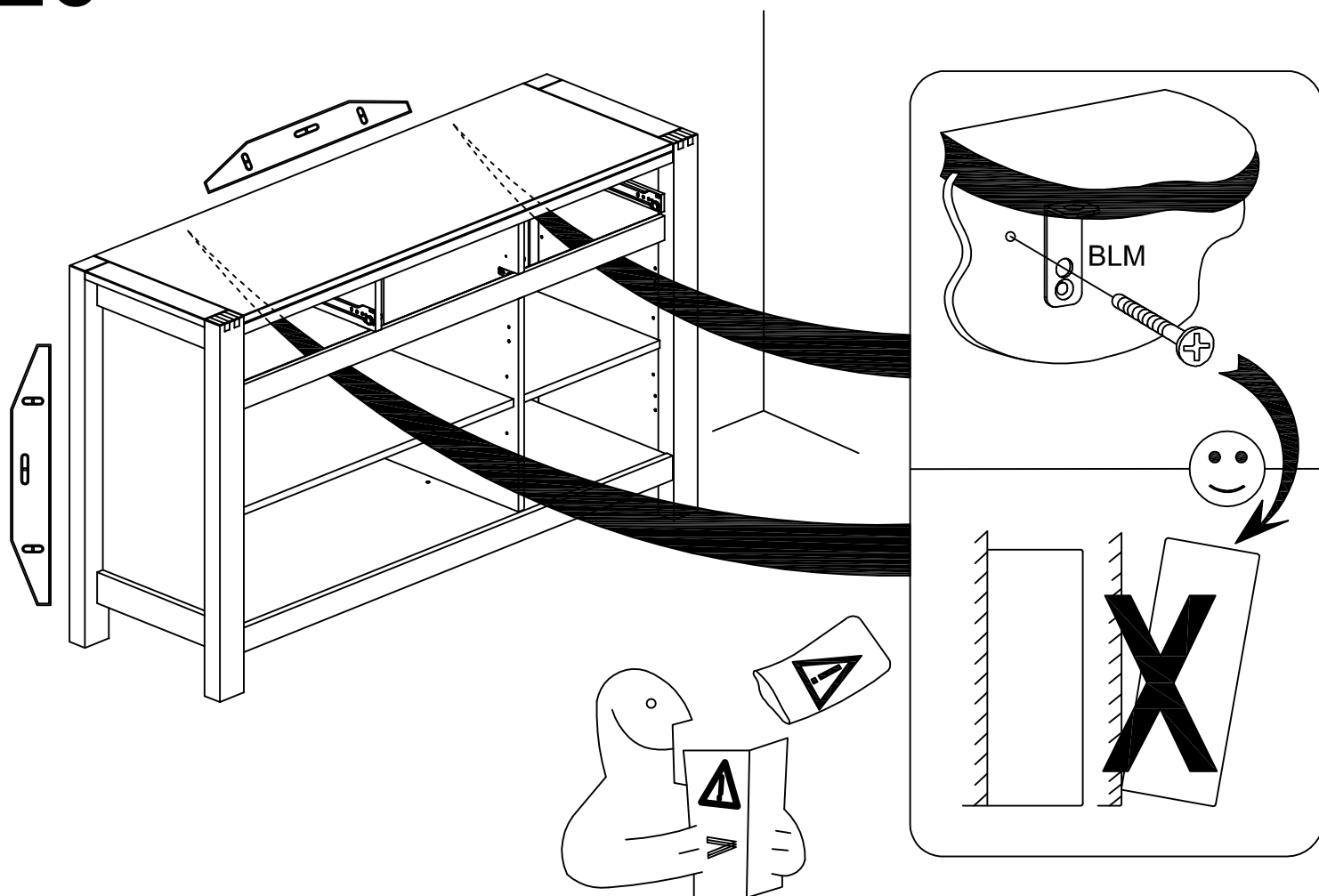
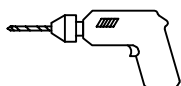

- (FR) Pour votre sécurité: Fixation du meuble au mur. Attention, la fixation doit être réalisée par une personne compétente car cela nécessite des chevilles adaptées à la nature de votre mur.
- (GB) For your own safety: Attach the furniture to the wall. Important: The furniture must be attached by a qualified person using dowels that are suited to the type of wall.
- (D) Für ihre Sicherheit: Befestigung des Möbelstücks an der Wand. Achtung, die Befestigung muss von einem Fachmann vorgenommen werden, weil sie an die Wand angepasste Dübel erfordert.
- (E) Para su seguridad: Fijación del meuble a la pared. Ojo! La fijación deberá llevarla a cabo una persona competente ya que necesitará unos tacos adaptados a tipo de pared.
- (PT) Para a sua segurança: Fixação do móvel na parede. Atenção, a fixação deve efectuada por uma pessoa competente, pois exige a utilização de cavilhas adaptadas à natureza da parede.
- (I) Per la vostra sicurezza: Fissaggio del mobile alla parete. Nota bene, il fissaggio deve essere eseguito da personale specializzato, poiché l'utilizzo di tasselli adattati alla parete.
- (NL) Voor uw veiligheid: Bevestiging van het meubel aan de muur. Let op, de bevestiging moet worden uitgevoerd door een bevoegd persoon, want hiervoor zijn pluggen nodig die specifiek geschikt zijn voor de betreffende muur.



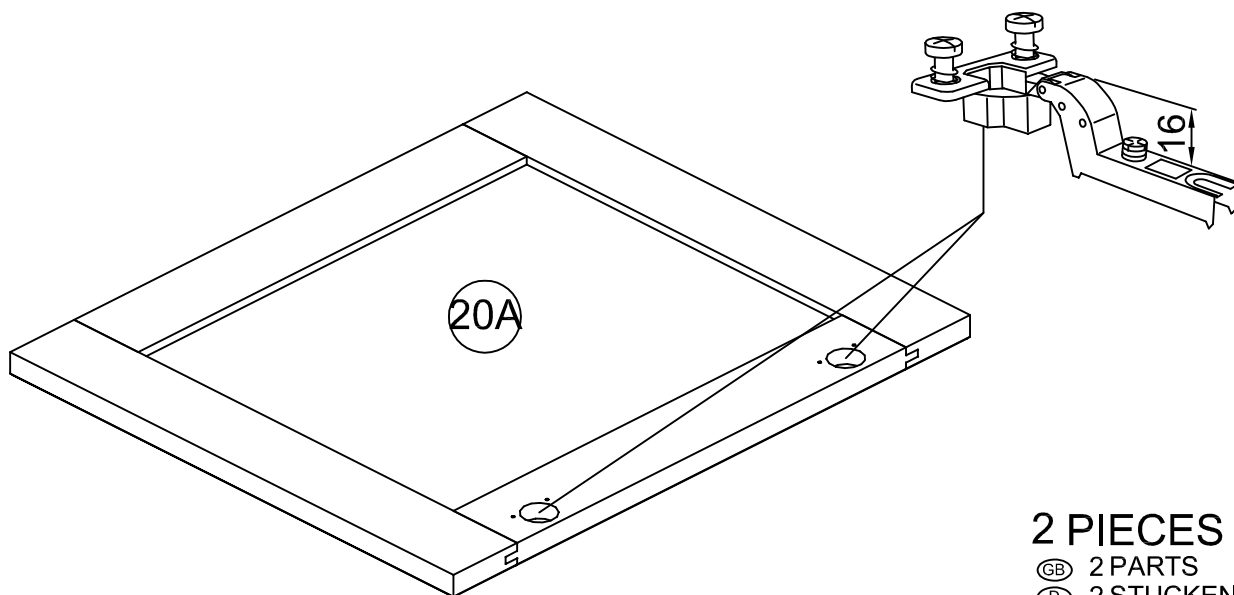
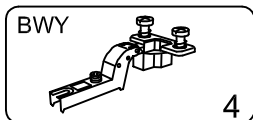

## 2 PIECES

- (GB) 2 PARTS
- (D) 2 STÜCKEN
- (E) 2 PIÉZAS
- (P) 2 PECAS
- (I) 2 PEZZI
- (NL) 2 STUKS

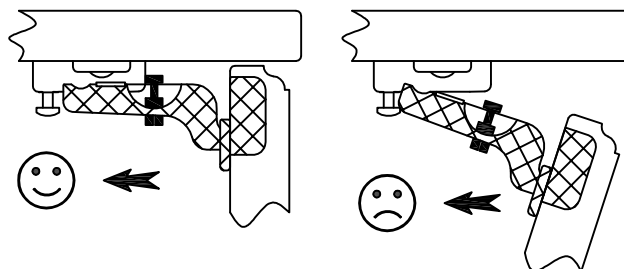
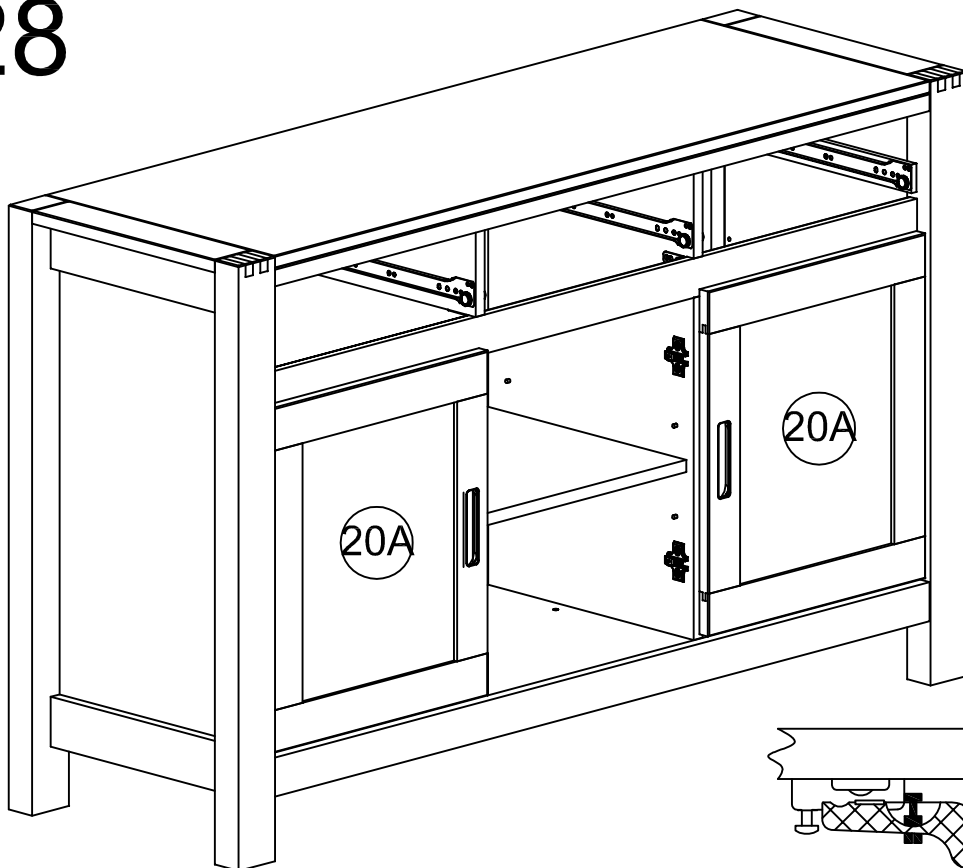

PHASE

BWX

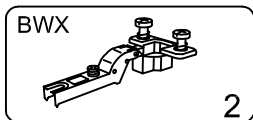

29

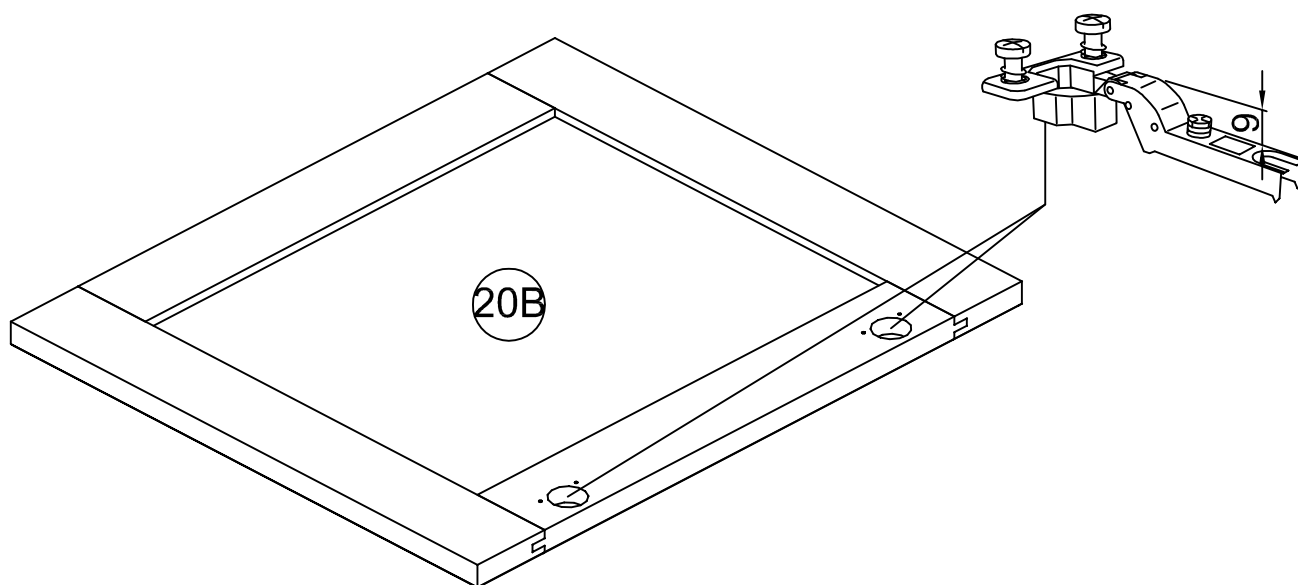

PHASE

30

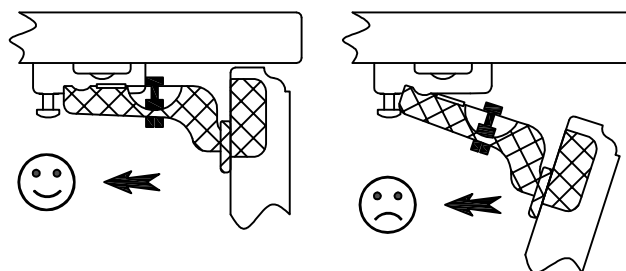
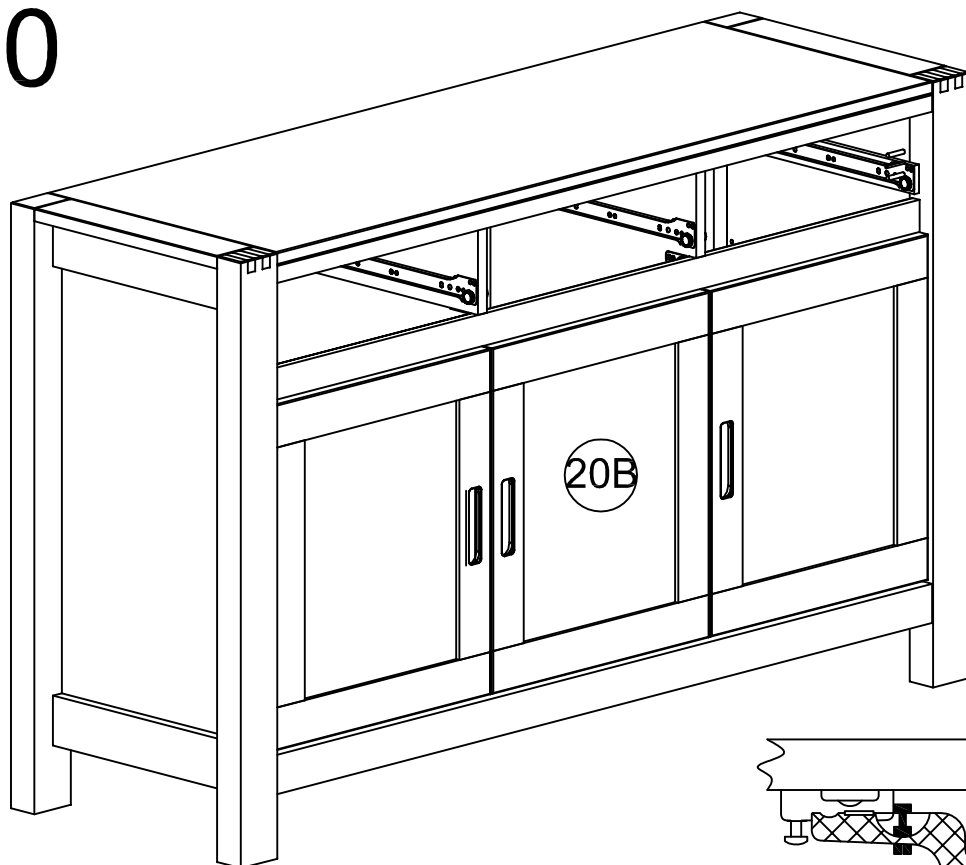

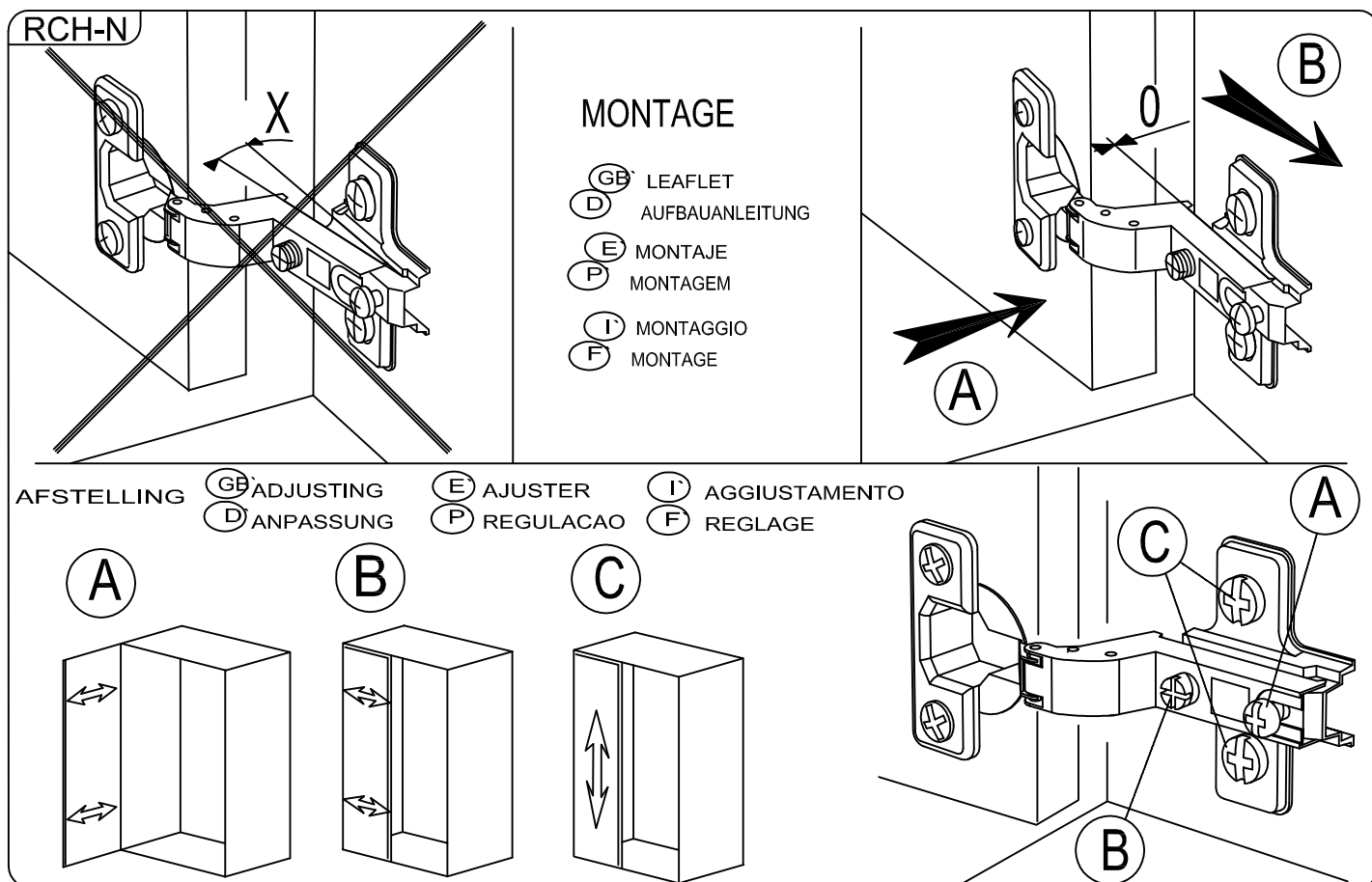
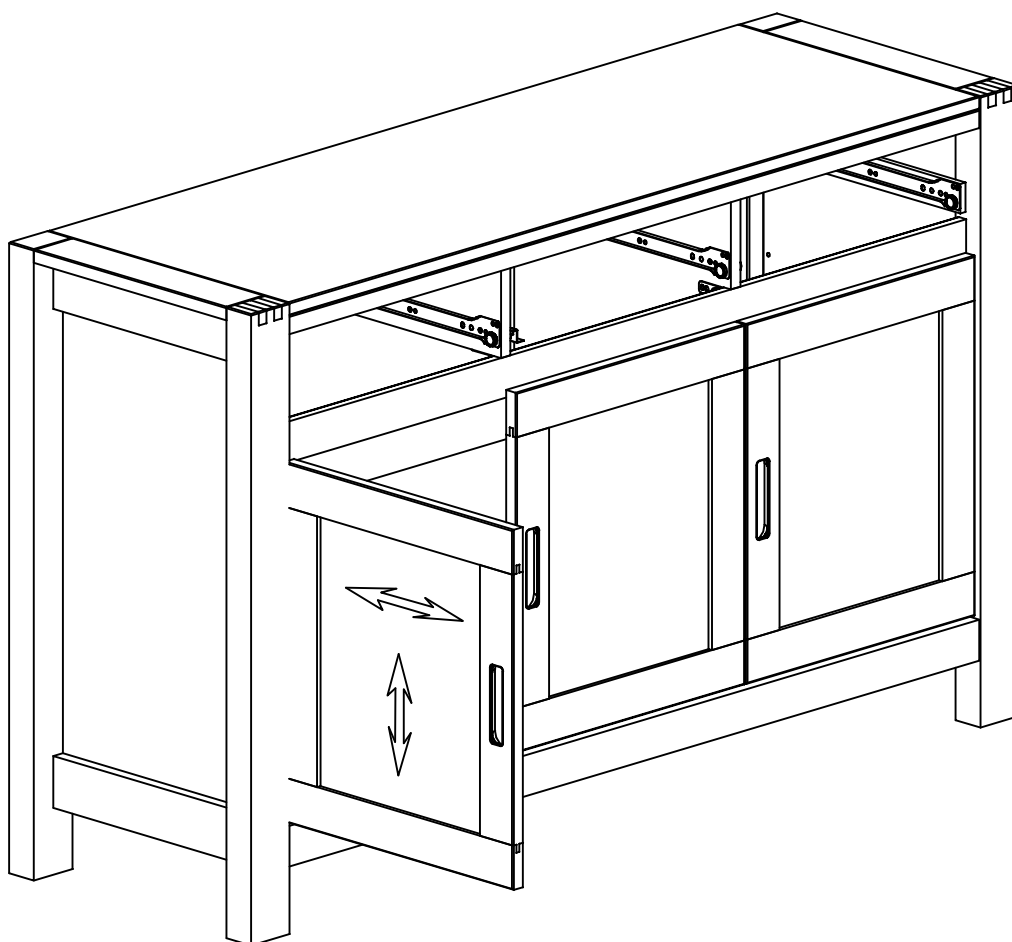

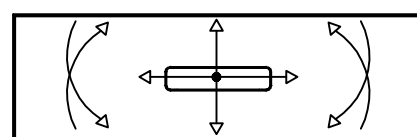
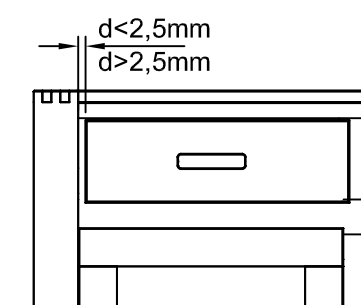
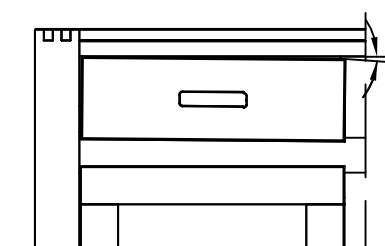
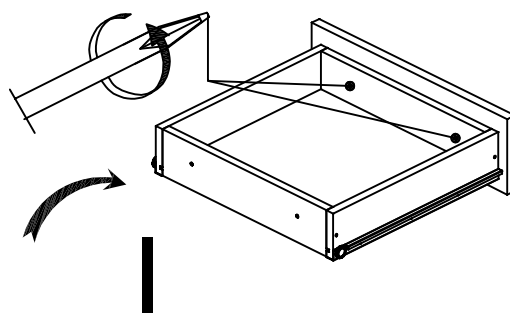
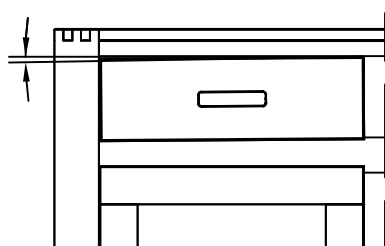
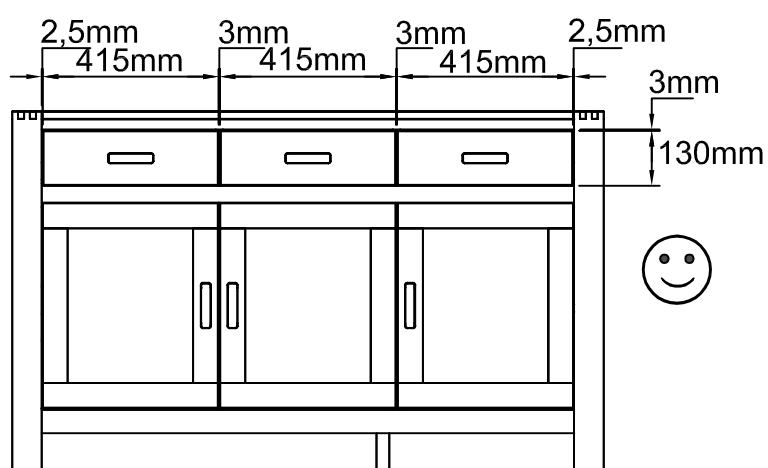
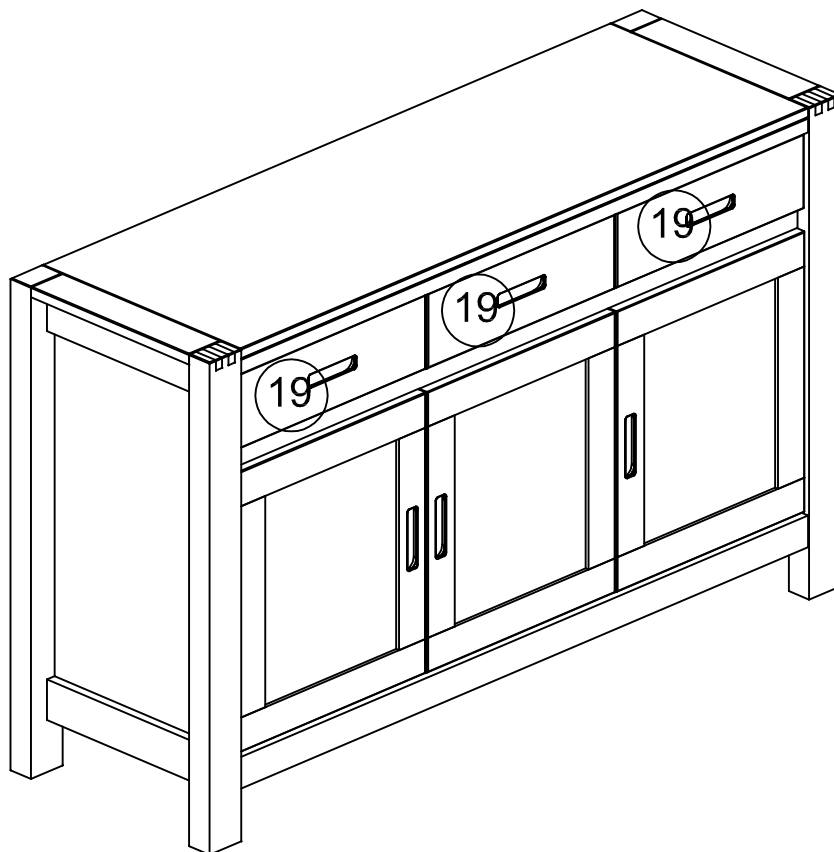

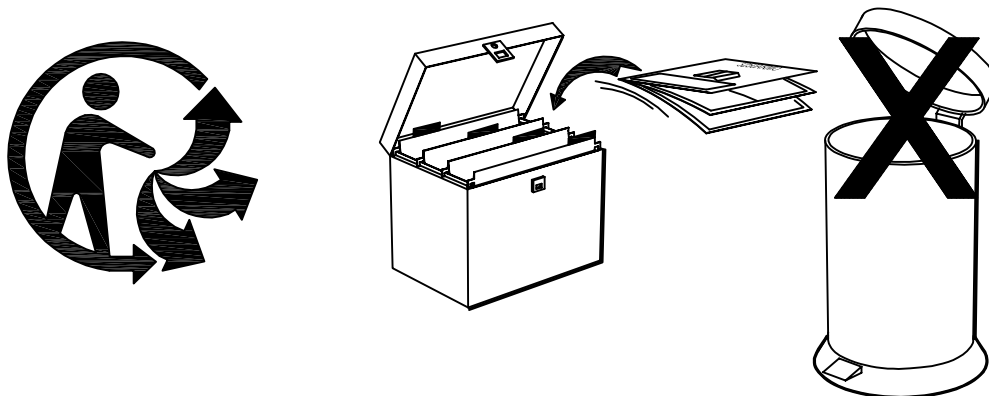

Faites un geste pour l'environnement en triant vos déchets d'emballage  
Make a gesture for the environment by sorting out your waste of packaging  
Machen Sie eine Bewegung für die Umwelt, ihre Verpackungsabfälle sortierend  
Haga un gesto para el medio ambiente escogiendo sus residuos de embalaje